



12 Lahinch Mews TORQUAY, VIC



3



2



2

## The Fairway Club, Torquay

The Fairway Club, Torquay - The surrounding landscape of The Sands Torquay forms a unique seaside location. Fostering a relationship with the views in and around the site was a significant driver for master planning the layout of the units. Residences are arranged in clusters, with landscaped openings between, allowing views out to the golf course and beyond. A centrally located green space offers exclusive amenity to all residents.

Individual units have been designed for a relaxed lifestyle with generous accommodation in a high-quality building. Level 1 living areas take advantage of significant views towards the golf course surrounds opening onto sheltered balconies for outdoor living. Kitchens incorporate a breakfast bar & island bench, conveniently located near balcony spaces. All units are designed for 6-star energy efficiency including hot water solar panels on the roof. Exterior materials are highly durable and easily maintained for long life. Interior fitments & stainless steel appliances are high quality, and all units come equipped with inte

**Price:** Contact Agent  
**Property Type:** Townhouse

# HAYDEN

Hayden Real Estate Ben Smith

0423050825

Torquay

samh@hayden.com.au

bens@hayden.com.au

# THE FAIRWAY CLUB - LAHINCH MEWS

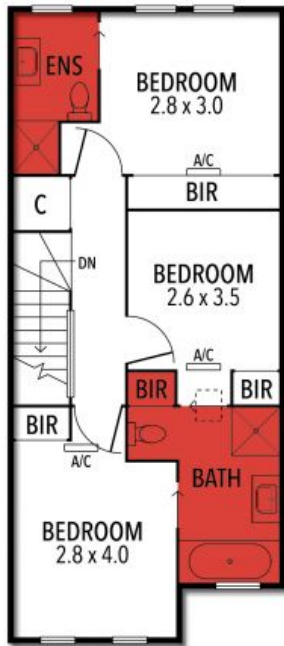

**SECOND FLOOR**

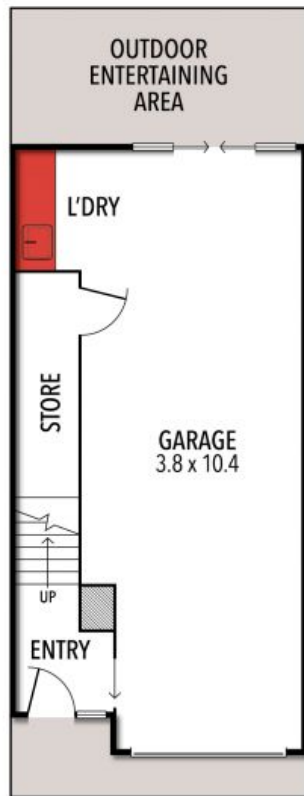

**GROUND FLOOR**

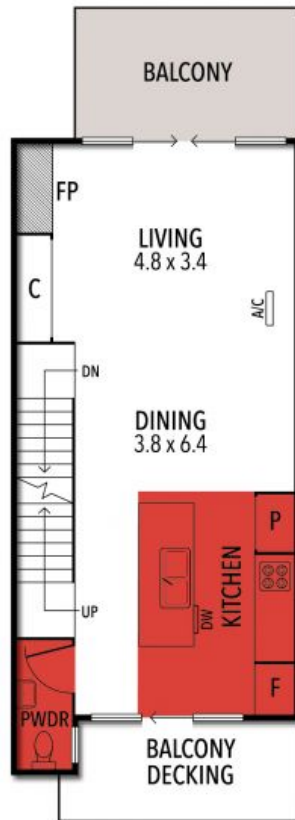

**FIRST FLOOR**



THE ABOVE PLAN IS AN ARTIST'S IMPRESSION ONLY, IT INCLUDES ELEMENTS THAT ARE FOR DISPLAY PURPOSES ONLY AND MAY NOT BE TO SCALE. LANDSCAPING SHOWN IS INDICATIVE ONLY. DIMENSIONS ARE APPROXIMATE.