



190 Shell Road OCEAN GROVE, VIC



3



2



1

Potential To Be Extraordinary

Easily personalized and just a short drive from the beach, this home will afford its owners a convenient and peaceful coastal lifestyle. The design boasts sunny rooms with floor-to-ceiling windows and dual north-south outlook from the living area. Solidly built from brick, and on a large allotment, it presents as a robust investment property, first home or great bones for a renovation/extension project (STCA).

The home's neutral decor and hardwood floors are appealing. The tidy kitchen/dining area has good proportions, and the kitchen features Euromaid electric oven, 900mm gas cooktop and large fridge cavity. The wide outlook over the backyard is ideal.

With some simple cosmetic refreshment, this bright home has real potential to be extraordinary! View without delay!

Price: \$440,000 - \$480,000

Property Type: House

Land: 546 m2

HAYDEN

Lynley Bassett

0448515925

lynley@haydenoceangrove.com.au

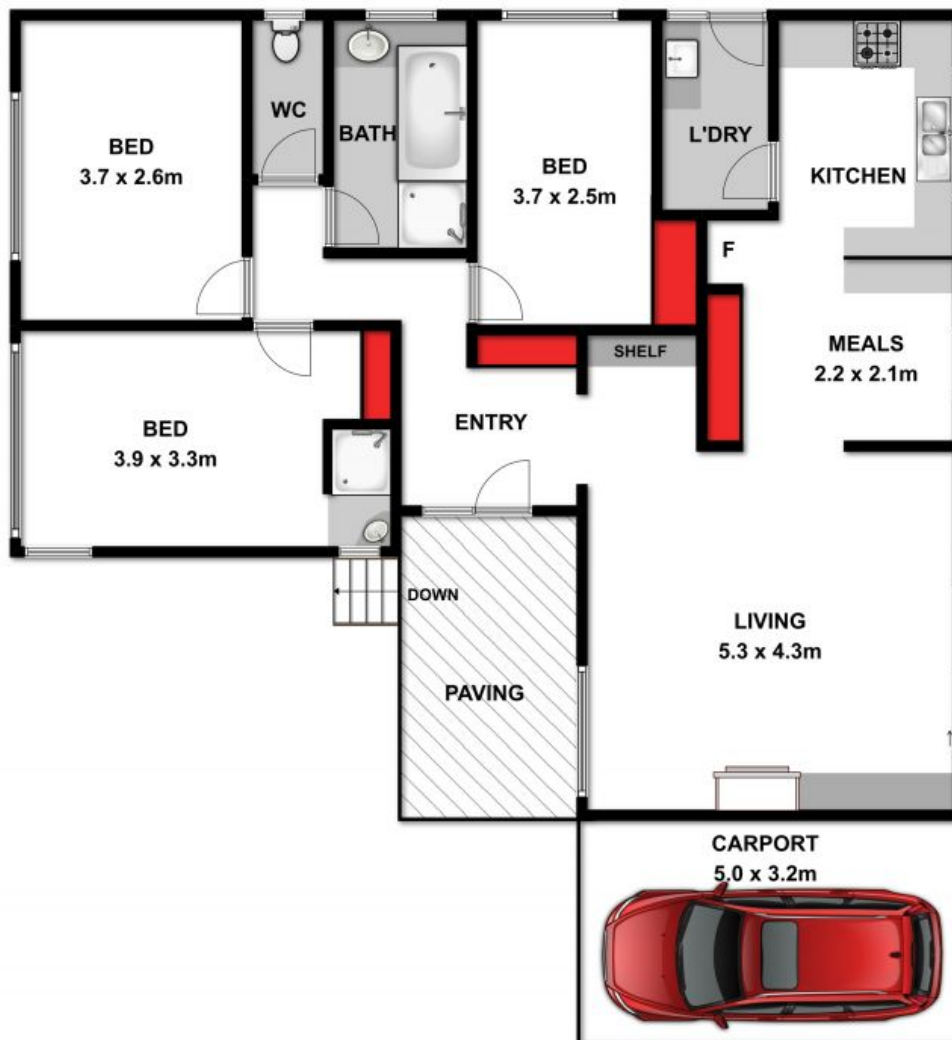

Approx Area 132.1m²

Whilst bwrn.com.au has made every attempt to ensure the accuracy of the floor plan contained here, measurements are approximate and no responsibility is taken for any error, omission, or mis-statement. This plan is for illustrative purposes only.



190 SHELL ROAD, OCEAN GROVE

HAYDEN

190 Shell Road

OCEAN GROVE, VIC