



4/20 The Esplanade TORQUAY, VIC



Esplanade Living - Two Bays

Price: \$1,099,000

Property Type: Unit

HAYDEN

Hayden Real Estate -

Torquay

samh@hayden.com.au

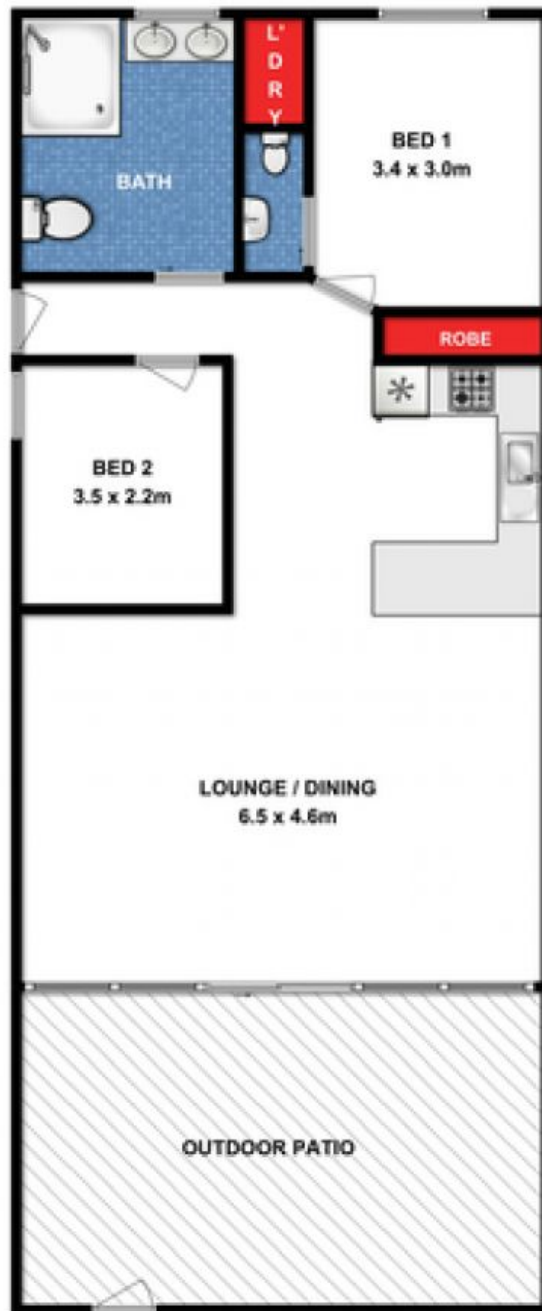

4/20 The Esplanade, Torquay



While every attempt has been made to ensure the accuracy of the floor plan contained here, measurements are approximate and no responsibility is taken for any errors, omissions or mis-statement. This drawing is for illustrative purposes only and should be used as such by any prospective purchaser. All dimensions stated are approximate and should not be taken as definite.