



DISCLAIMER: This drawing is indicative only & all measurements are approximate.



72-74 High Street MOOLAP, VIC



3



1



8

## SOLD BEFORE AUCTION

Calling all tradies!

Situated on a corner block of 1920m2 (approx.), this property offers buyers a myriad of options! Families will love that they can move straight into this beautifully updated home, while the numerous large sheds will impress tradies. Situated close to the Moolap industrial zone, this property also offers immense value for commercial businesses that are searching for extra space.

The Moolap Primary School and Moolap Reserve are a short stroll from your front door, while easy access to public transport keeps you connected to the Geelong CBD. A brief drive will find you at the Bellarine Highway shops, ensuring you're never far from life's necessities.

With new carpet, new Spotted Gum floating floors, and freshly painted interiors throughout, this home is waiting for you to move in and enjoy. A wood heater creates a cosy ambience in the front lounge, which flows through to the kitchen/dining zone. The spic-and-span kitchen is equipped with a built-in pantry, appliances (oven, gas hob, rangehood, double-dra

**Price:** \$600,000 - \$660,000

**Property Type:** House

HAYDEN

**Karen Purcell**

0448510143

karenp@haydenleopold.com.au

**Hugh McKewan**

0417 538 779

hugh@haydenoceanogrove.com.au

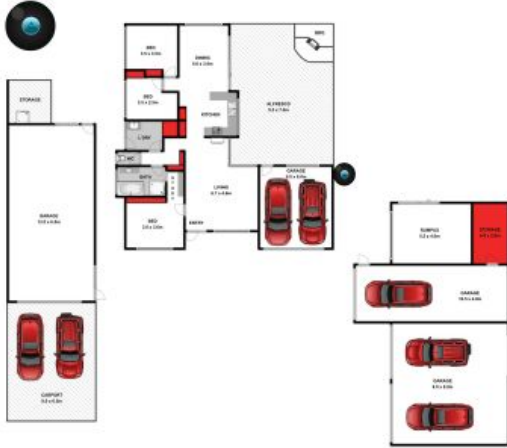

Approx Area 273.3m<sup>2</sup>

Whilst [bwrn.com.au](http://bwrn.com.au) has made every attempt to ensure the accuracy of the floor plan contained here, measurements are approximate and no responsibility is taken for any error, omission, or mis-statement. This plan is for illustrative purposes only.



**72-74 High Street, Moolap**



**72-74 High Street**

**MOOLAP, VIC**