



7 Alchera Court CLIFTON SPRINGS, VIC



Plenty of Potential in a Prime Position

Price: \$350,000 - \$375,000
Property Type: House
Land: 649 m2

HAYDEN

Hayden Real Estate -

Ocean Grove
samh@hayden.com.au

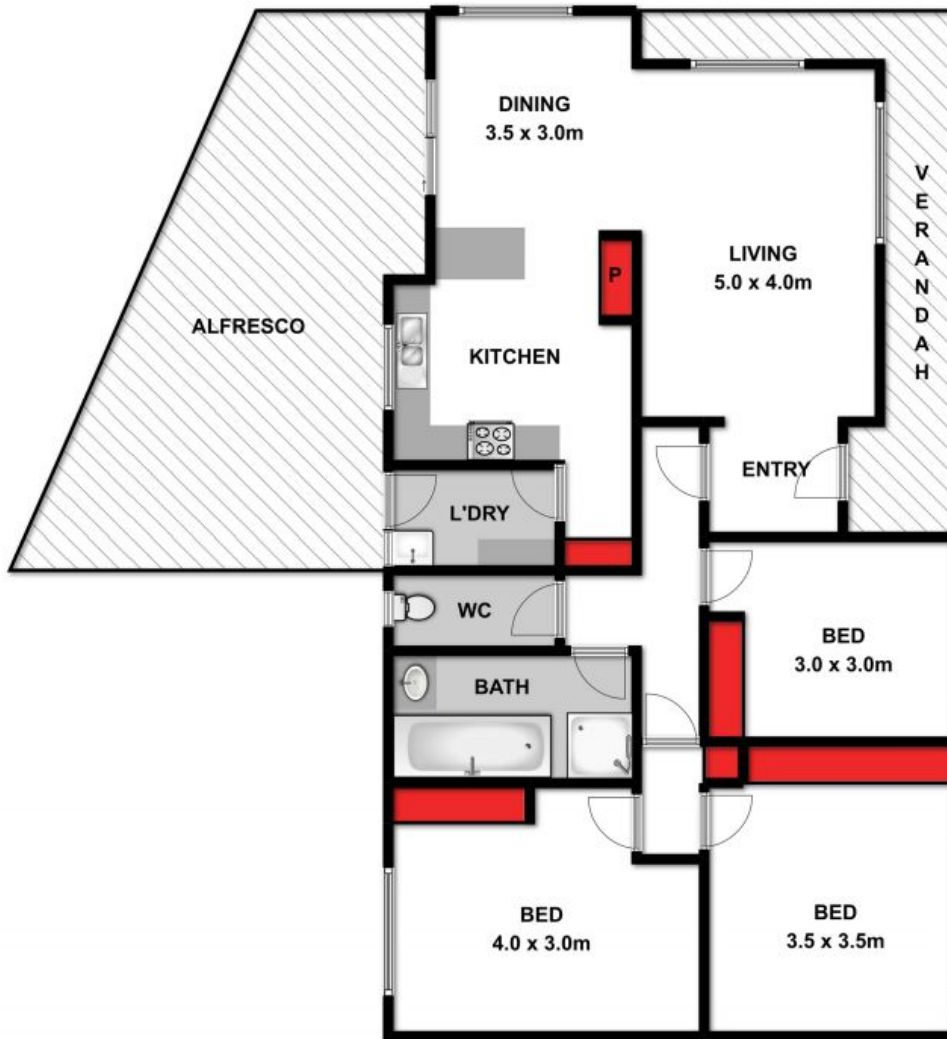

Approx Area 105m²

Whilst bwrn.com.au has made every attempt to ensure the accuracy of the floor plan contained here, measurements are approximate and no responsibility is taken for any error, omission, or mis-statement. This plan is for illustrative purposes only.



7 ALCHERA COURT, CLIFTON SPRINGS

HAYDEN

7 Alchera Court

CLIFTON SPRINGS, VIC