



10 Muirfield Avenue JAN JUC, VIC



3



2



2

Unrivalled Architectural Excellence

Enjoy entertaining in the stunning chefs kitchen highlighted by Corian benchtops, extensive high gloss cabinetry and fully integrated Miele appliances. Soaring ceilings, expansive window treatments and custom joinery showcase the open plan living and dining zones which flow beautifully to outdoor entertaining. Crisp white walls, a neutral colour palette and light filled interiors complimented by warm Blackbutt timber floor boards all combine to give this cleverly designed home a relaxed yet truly functional vibe.

The well proportioned master suite is highlighted by a full louvre window wall and further complimented by additional joinery including a substantial WIR and ensuite including a frameless double shower, double basin, Caesar benchtops and heated towel rail. The sleeping quarters continue with a further 2 generous bedrooms with BIRs serviced by a central family bathroom and adjacent powder room. An adjoining second living can be quickly and cleverly modified into a fourth bedroom by simply closing the full height hidden cavity slider, opening cabinetry and withdrawing the inbuilt Hafele Bettlift foldaway bed/s. An oversized

Price: \$1,695,000

Property Type: House

Land: 668 m2

HAYDEN

Ben Smith

0423050825

bens@hayden.com.au

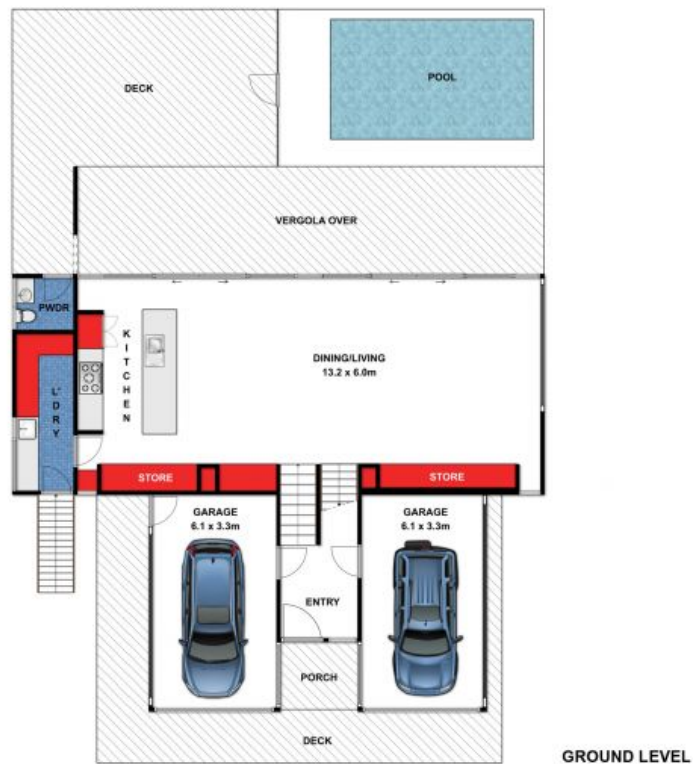

10 MUIRFIELD AVENUE, JAN JUC



While every attempt has been made to ensure the accuracy of the floor plan contained here, measurements are approximate and no responsibility is taken for any errors, omissions or miss-statement. This drawing is for illustrative purposes only and should be used as such by any prospective purchaser. All dimensions stated are approximate and should not be taken as definite.

10 Muirfield Avenue

JAN JUC, VIC