



9 Cooney Street MOOLAP, VIC



4



2



2

Large Family Home On 1.4 Acres in Moolap!

Set upon approx. 5666m², the possibilities of this property are endless (STCA)! The family home is ready for you to move straight into, while the large north-facing backyard is bursting with potential. With an expansive parcel of land sectioned off at the rear of the property, tradies can create their ultimate workspace (STCA)!

The spotless kitchen is equipped with a step-in pantry, oven, gas hob, and rangehood.

Families will appreciate that the generous lounge allows everyone to spread out and enjoy their own personal space.

Zoned to one end of the home, the Master Bedroom provides busy parents with a quiet place to relax. The walk-in robe leads to the en suite, which is complete with a shower and toilet.

The remote double lock-up garage provides secure parking. With vehicle access to the rear parcel of land, tradies will be in their element. The addition of a few work sheds could transform the space into a tradie's paradise (STCA), while commercial businesses will see t

Price: \$790,000 - \$865,000

Property Type: House

Land: 5666 m²

HAYDEN

Karen Purcell

0448510143

karenp@haydenleopold.com.au

Hugh McKewan

0417 538 779

hugh@haydenoceanogrove.com.au

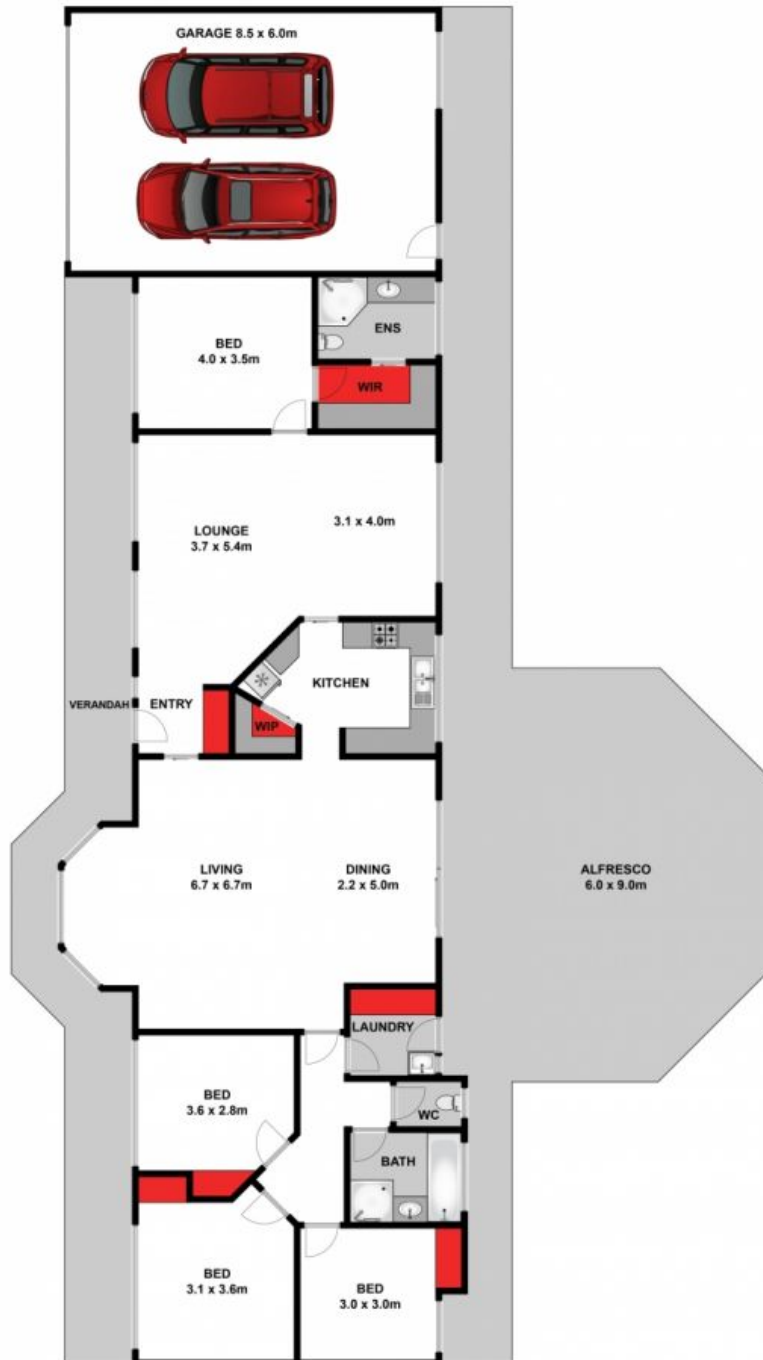

Approx. Area 187m²

Whilst bwrn.com.au has made every attempt to ensure the accuracy of the floor plan contained here, measurements are approximate and no responsibility is taken for any error, omission, or mis-statement. This plan is for illustrative purposes only.



9 Cooney Street, Moolap



9 Cooney Street

MOOLAP, VIC