



37 The Court LEOPOLD, VIC



3



2



2

## Make Your Home Owner Dreams A Reality!

If you're dreaming of owning your first home, searching for a terrific investment property, or looking for a great location to raise your family, this is the one for you!

Boasting easy access to Myuna Reserve's playground, children won't have to venture far for some outdoor fun. Public transport, the Ash Road shops, and Leopold Kindergarten are all a leisurely stroll from your front door, while Leopold Primary School and the Gateway Plaza are within easy reach.

The original interiors grant you the option to move straight in, while also offering scope for further enhancement (STCA). The lounge and dining zone welcome you into the home, creating a cosy ambience from the moment you step through the front door. Raked ceilings create an overwhelming feeling of space in the adjacent main living zone, which is also awash in northern and western light. The kitchen is well equipped with timber cabinetry, a built-in pantry, and cooking appliances (wall oven, 900mm electric cooktop, rangehood). Parents will appreciate that while they're busy prepping meals, they can also keep an eye on you

**Price:** \$480,000 - \$510,000

**Property Type:** House

**Land:** 599 m2

# HAYDEN

**Karen Purcell**

0448510143

karenp@haydenleopold.com.au

**Hugh McKewan**

0417 538 779

hugh@haydenoceangrove.com.au

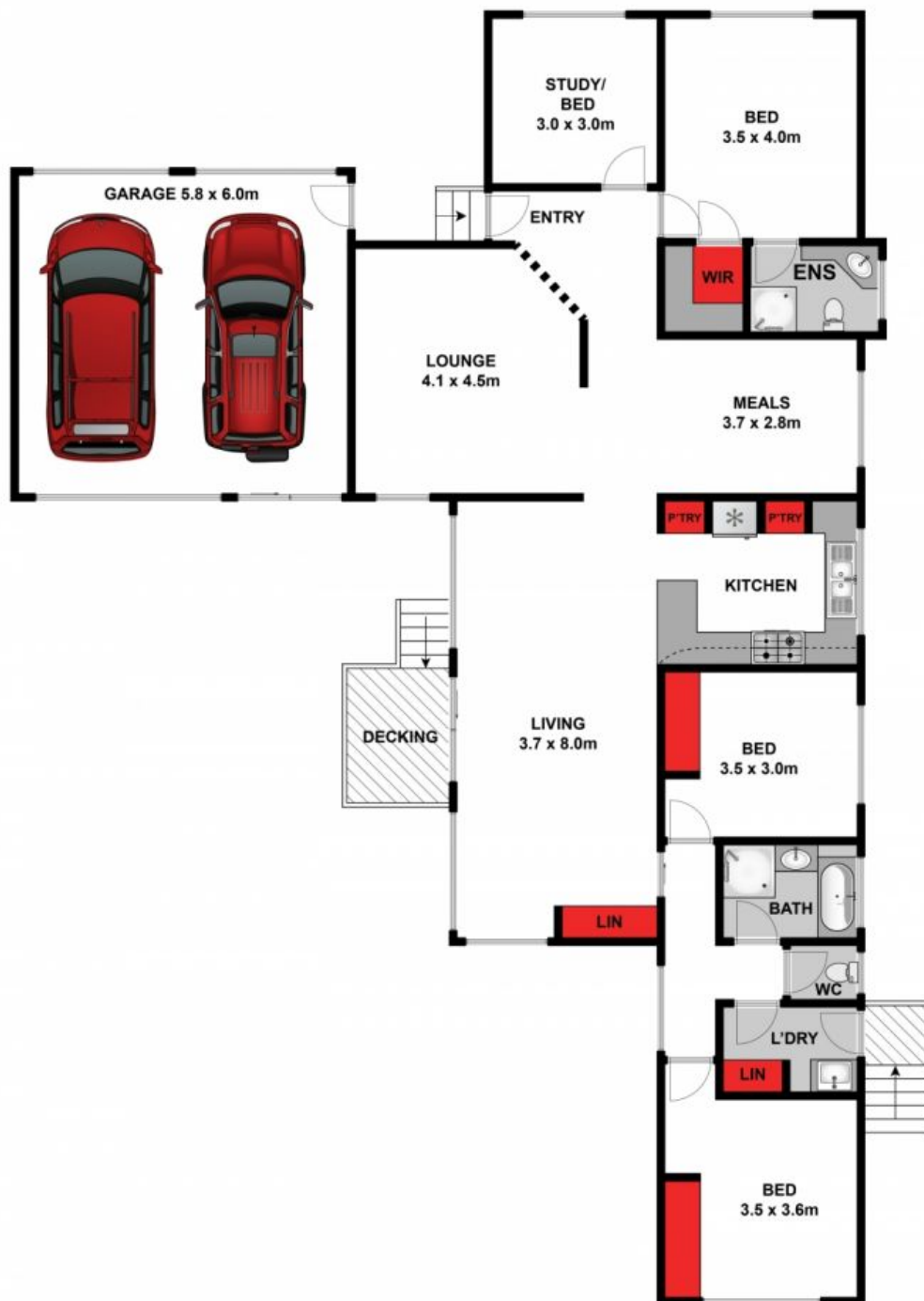

Approx. Area 156m<sup>2</sup>

Whilst [bwm.com.au](http://bwm.com.au) has made every attempt to ensure the accuracy of the floor plan contained here, measurements are approximate and no responsibility is taken for any error, omission, or mis-statement. This plan is for illustrative purposes only.



**37 The Court, Leopold**

**HAYDEN**

**37 The Court**

**LEOPOLD, VIC**