



16/34 Murradoc Road DRYSDALE, VIC

Invest in Commercial Property in a Growing Region

**Price:** \$330,000 - \$360,000 + GST

**Property Type:** Industrial

**HAYDEN**

Hayden Real Estate -

**Ocean Grove**  
sami@hayden.com.au

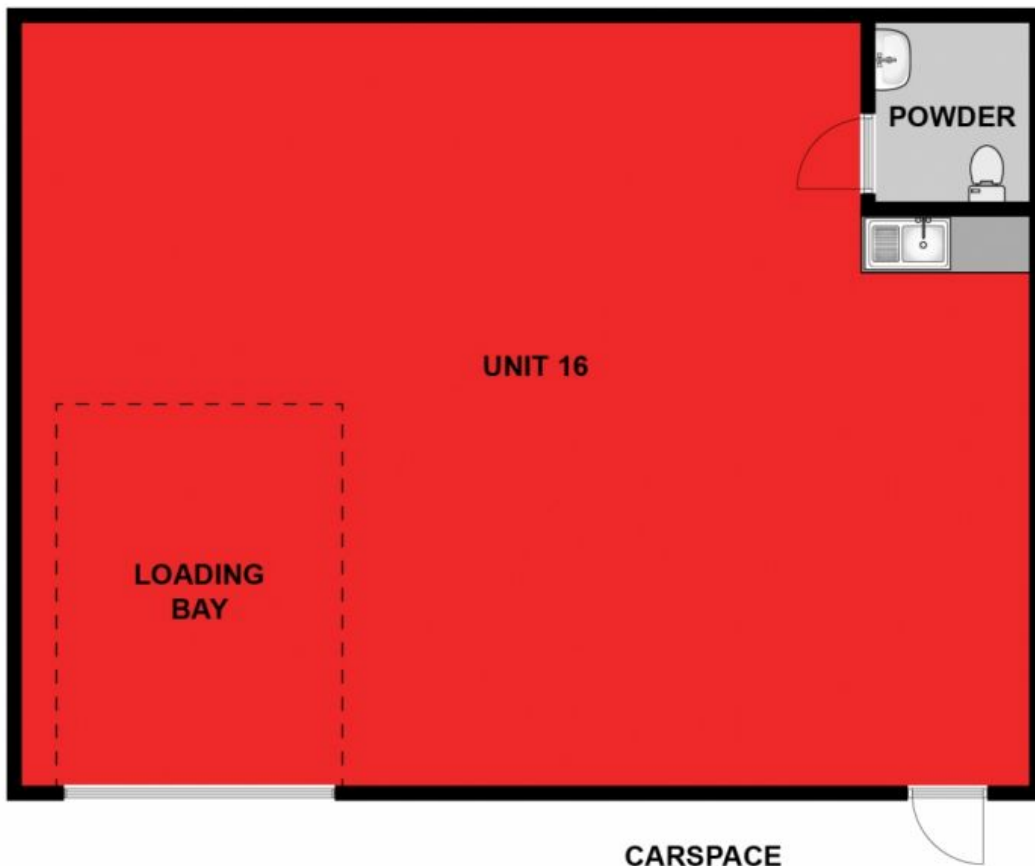

Approx. Area 112m<sup>2</sup>

Whilst [bwrn.com.au](http://bwrn.com.au) has made every attempt to ensure the accuracy of the floor plan contained here, measurements are approximate and no responsibility is taken for any error, omission, or mis-statement. This plan is for illustrative purposes only.

**16/34 Murradoc Road, Drysdale**

**HAYDEN**

**16/34 Murradoc Road**

**DRYSDALE, VIC**