



5 Leopold Court LEOPOLD, VIC



4



2



2

## A Place To Call Home!

Sitting pretty upon approx. 855m<sup>2</sup>, this spacious residence has something to impress every family member!

An effortless lifestyle is part of the package with the Leopold Primary School, Leopold Memorial Reserve sporting grounds, and the popular Gateway Plaza all a short walk from your front door. Public transport is also within easy reach, along with tranquil Gateway Sanctuary and easy access to the Bellarine Rail Trail. A short drive will find you on the scenic Bellarine Peninsula or in the heart of Geelong.

The formal lounge and dining area provides yet another option for hosting loved ones, while the family room opens onto the backyard - offering immense versatility as a billiards room, teenage retreat, or kids play space.

The front study is ideal for home business owners or students who need a quiet place to hit the books. Three additional bedrooms with built-in robes, main bathroom with shower and claw-foot tub, separate toilet, and laundry with external access, are tucked away in a sep

**Price:** \$600,000 - \$660,000

**Property Type:** House

**Land:** 855 m<sup>2</sup>

HAYDEN

**Karen Purcell**

0448510143

karenp@haydenleopold.com.au

**Hugh McKewan**

0417 538 779

hugh@haydenoceanogrove.com.au

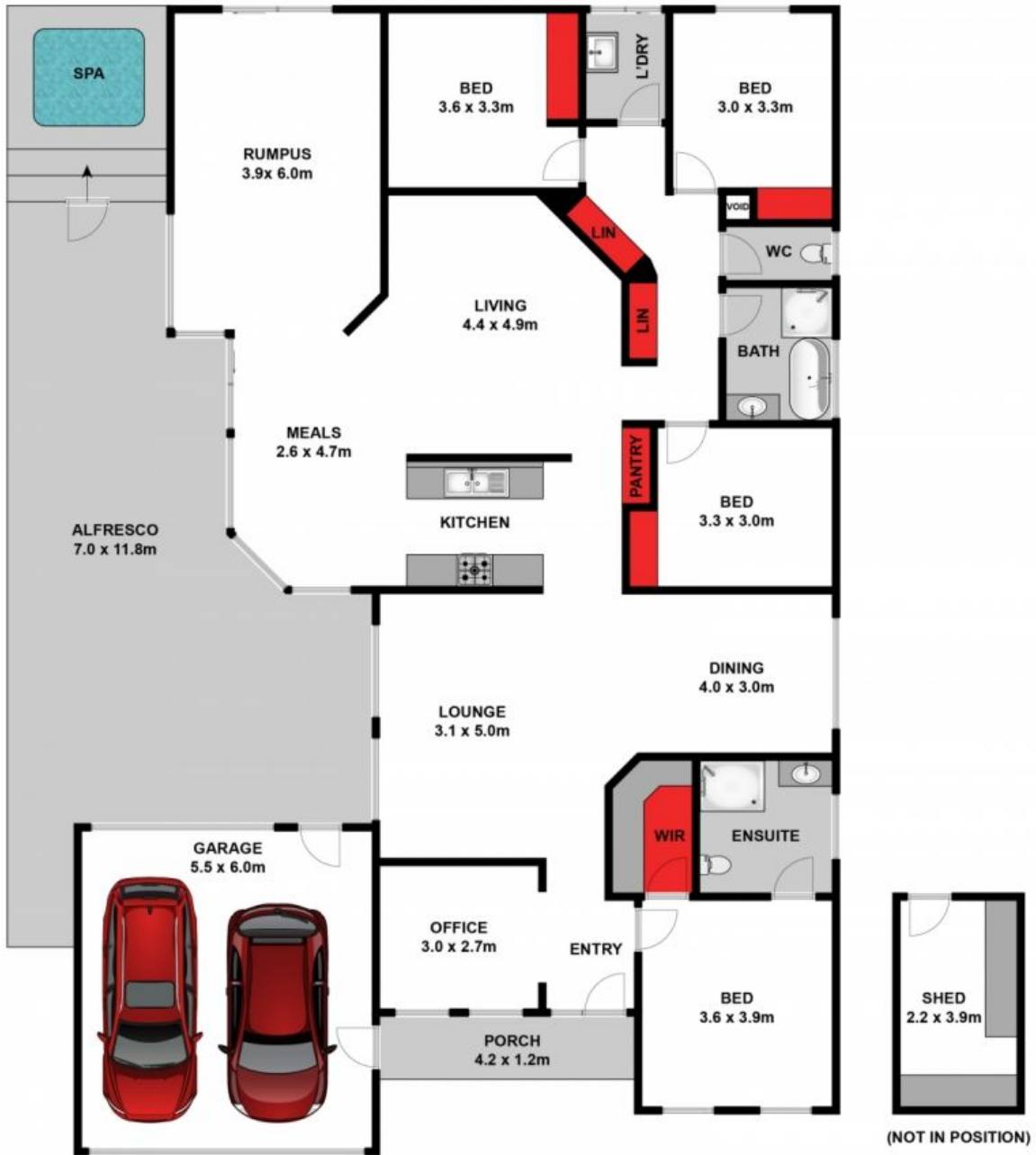

Approx. Area 206m<sup>2</sup>

Whilst [bwrn.com.au](http://bwrn.com.au) has made every attempt to ensure the accuracy of the floor plan contained here, measurements are approximate and no responsibility is taken for any error, omission, or mis-statement. This plan is for illustrative purposes only.



## 5 Leopold Court, Leopold

**HAYDEN**

5 Leopold Court

LEOPOLD, VIC