



7 Parkside Crescent TORQUAY, VIC



3



1



2

### Prime Position On Parkside

Here's your opportunity to secure a massive 734sqm block overlooking the picturesque Deep Creek Reserve in old Torquay.

Currently a delightful three bedroom brick residence, refurbished approximately 10 years ago, the home is perfect for the holiday maker, downsizer or small family.

For the larger family looking for the ideal home site the options are endless with plenty of room to extend forwards, back, or up with the possibility of ocean views. (S.T.C.A.)

This very private pocket of Torquay is walking distance to schools, shops, public transport and the beach is accessible by a lovely walk along the nature reserve.

**Price:** AUCTION: SAT 24th NOV @ 11:00am  
**Property Type:** House  
**Land:** 735 m2



Hayden Real Estate Ben Smith

0423050825

Torquay  
samh@hayden.com.au

bens@hayden.com.au

# 7 PARKSIDE CRESCENT, TORQUAY

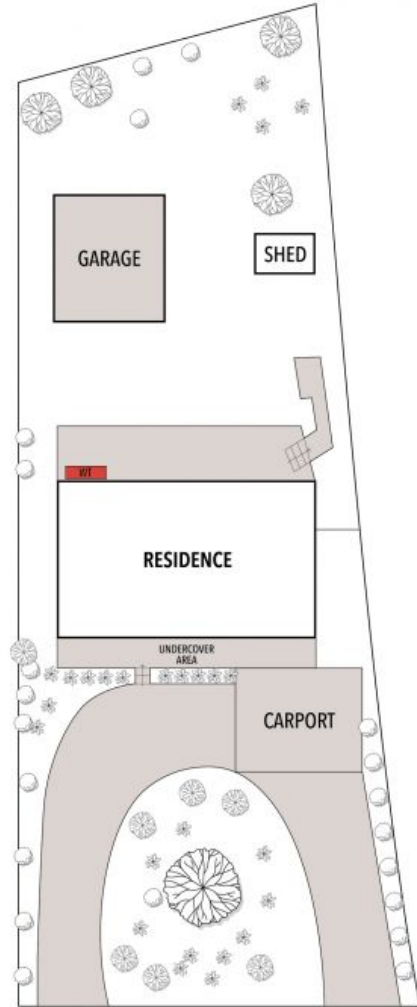
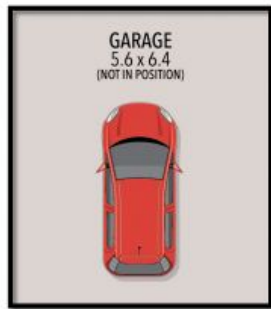

THE ABOVE PLAN IS AN ARTIST'S IMPRESSION ONLY, IT INCLUDES ELEMENTS THAT ARE FOR DISPLAY PURPOSES ONLY AND MAY NOT BE TO SCALE. LANDSCAPING SHOWN IS INDICATIVE ONLY. DIMENSIONS ARE APPROXIMATE.