



40 Blake Drive LEOPOLD, VIC



4



2



2

The One You've Been Searching For!

The open plan living/dining/kitchen zone creates a generous area for the whole family to come together and share stories of their day. With enough space to set up a study nook, busy parents will be able to keep an eye on children as they complete their homework. The kitchen is well equipped with a built-in pantry, breakfast bar, and stainless steel appliances inc. a dishwasher, oven, gas hob, and rangehood.

Price: \$499,000 - \$515,000
Property Type: House
Land: 505 m2

HAYDEN

Karen Purcell

0448510143

karenp@haydenleopold.com.au

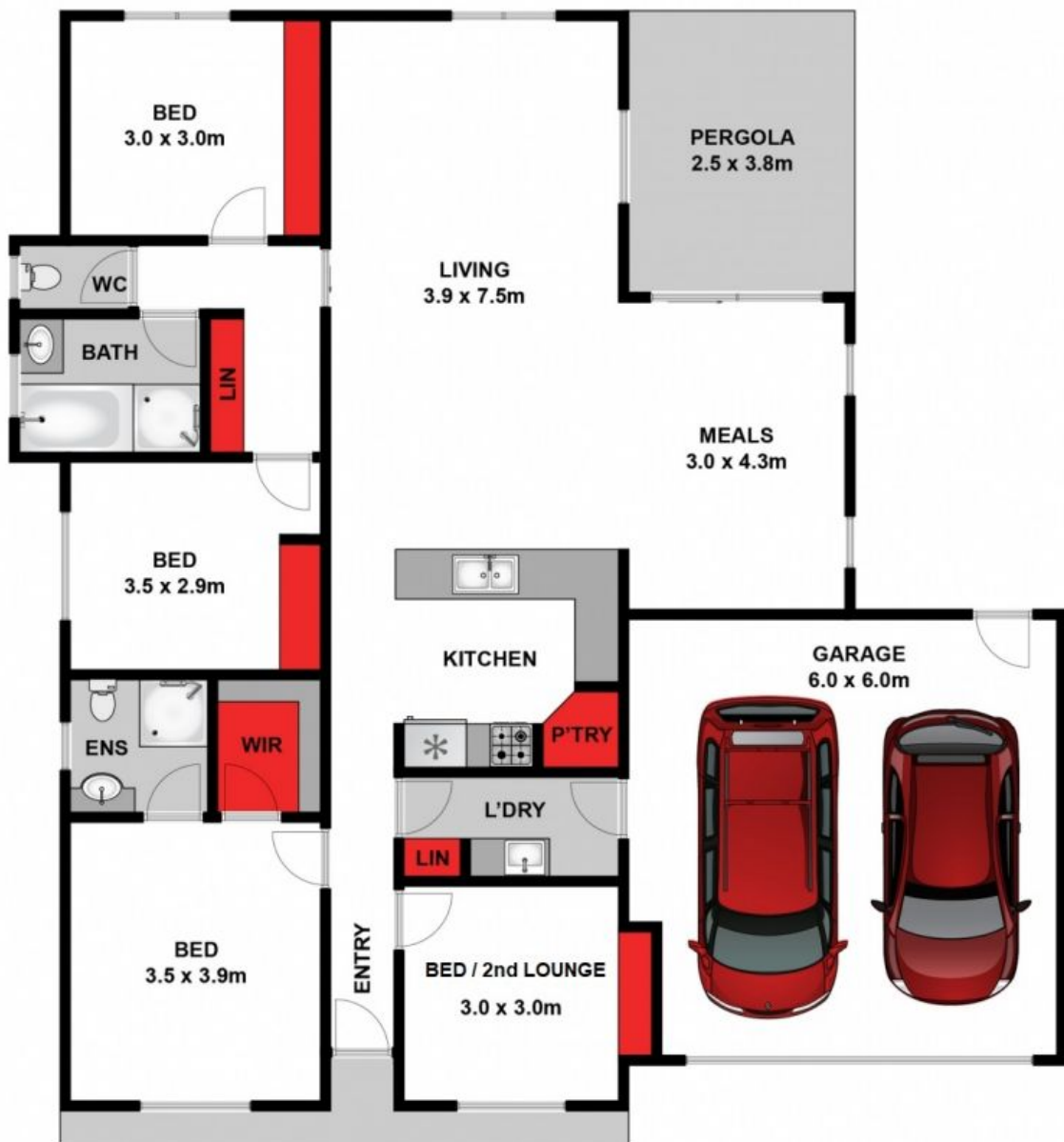

Approx. Area 174m²

Whilst bwrn.com.au has made every attempt to ensure the accuracy of the floor plan contained here, measurements are approximate and no responsibility is taken for any error, omission, or mis-statement. This plan is for illustrative purposes only.



40 Blake Drive, Leopold

HAYDEN

40 Blake Drive

LEOPOLD, VIC