



19 The Crescent LEOPOLD, VIC



4



2



3

Life Will Be A Dream!

Life will be a dream with this sensational family residence! Featuring beautifully presented interiors, breathtaking views over the bay and enchanting gardens, this bespoke one-owner home is simply divine!

Completely refurbished approx. six years ago, this home leaves you nothing to do except move in and enjoy. The immaculate interiors exude a breezy ambience throughout, while the surrounding gardens provide a picturesque backdrop to every window.

The kitchen oozes warmth with Tasmanian Blackwood timber cabinetry and black benchtops. The large walk-in pantry with powerpoints will impress, while appliances include a Miele dishwasher and Kleenmaid oven, gas hob, rangehood.

The dreamy Master Bedroom is graced with a large walk-in robe and en suite with shower, single vanity and toilet. A powder room completes the upper level. Three additional bedrooms all with double built-in robes, main bathroom, separate toilet and large laundry with sto

Price: \$845,000 - \$895,000

Property Type: House

Land: 1304 m2

HAYDEN

Karen Purcell

0448510143

karenp@haydenleopold.com.au

Hugh McKewan

0417 538 779

hugh@haydenoceanogrove.com.au

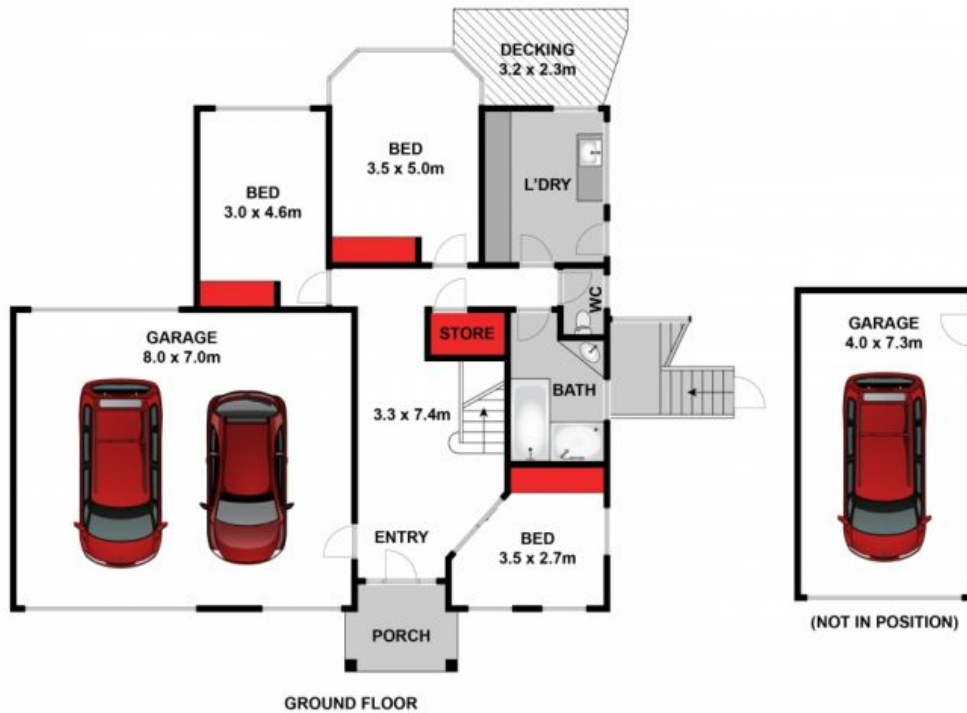

Approx House Area 288m²

Whilst bwrn.com.au has made every attempt to ensure the accuracy of the floor plan contained here, measurements are approximate and no responsibility is taken for any error, omission, or mis-statement. This plan is for illustrative purposes only.



19 The Crescent, Leopold

HAYDEN

19 The Crescent

LEOPOLD, VIC