



1/12 Kylemore Court LEOPOLD, VIC



3



2



1

## Superb Townhouse Living In Leopold!

When it comes to low-maintenance living, it doesn't get much better than this! Graced with elegant interiors and a north-facing outdoor zone, you'll need to act swiftly to secure this superb lifestyle!

High ceilings and glossy floor tiles enhance the immaculate interiors, which exude a classic feel throughout. Showcasing square-set ceilings, the open plan living/dining/kitchen zone creates the heart of the home. You'll adore coming home to this light-filled living zone after a busy day at work! The kitchen exudes timeless elegance with stone benchtops, a built-in pantry, and 900mm stainless steel oven, gas hob, and rangehood. Upgrade your lifestyle in an instant with this quality home! Inspection will delight!

**Price:** \$430,000 - \$460,000

**Property Type:** Unit

**Land:** 341 m2

# HAYDEN

**Karen Purcell**

0448510143

karenp@haydenleopold.com.au

**Hugh McKewan**

0417 538 779

hugh@haydenoceanogrove.com.au

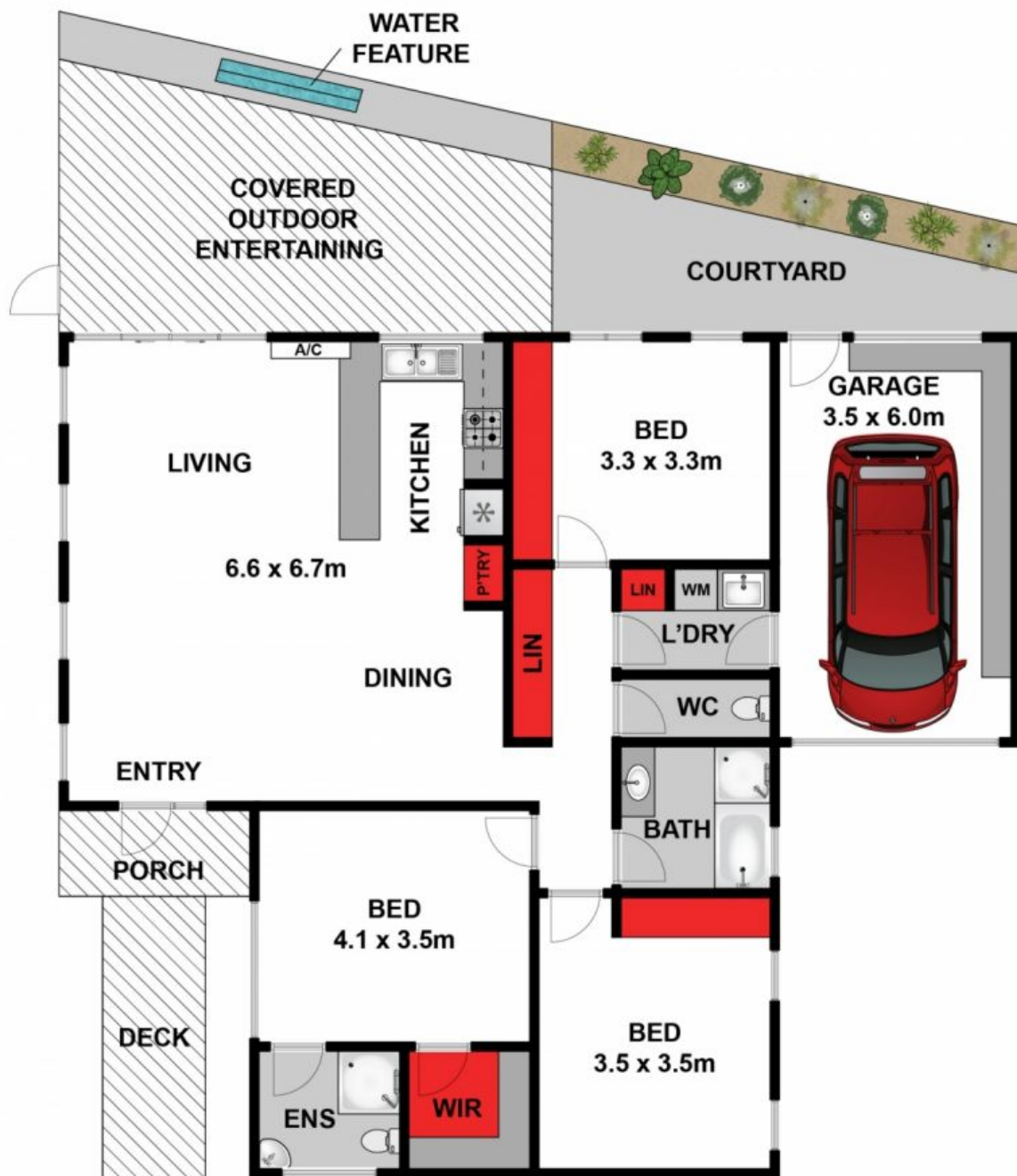

Approx House Area 142m<sup>22</sup>

Whilst [bwrn.com.au](http://bwrn.com.au) has made every attempt to ensure the accuracy of the floor plan contained here, measurements are approximate and no responsibility is taken for any error, omission, or mis-statement. This plan is for illustrative purposes only.



1/12 Kylemore Court, Leopold

**HAYDEN**

1/12 Kylemore Court

LEOPOLD, VIC