



32 Hannan Crescent LEOPOLD, VIC



4



2



3

An Entertainer's Dream Home

Built to exceptional standards with immaculate interiors is this double-storey sandstone residence set in a peaceful Leopold neighbourhood. With space, quality and convenient location - this property has it all!

Open the front door to a welcoming entrance and onto a generous main living area that houses a surround sound system and projector points. Adjacent is a contemporary kitchen that features a D'Amani oven and five-burner stove top, Bosch dishwasher, breakfast bar, corner pantry and spacious dining room with bay windows.

Accommodation is more than comfortable with a measurable master bedroom upstairs beside a large WIR and dual access en suite. A fourth bedroom with a laundry chute to simplify life chores is situated on the other side of the shared bathroom, complete with a spa bath and

Price: \$680,000 - \$725,000
Property Type: House
Land: 684 m2

HAYDEN

Penny Dawson

0448510200

penny@haydenoceanogrove.com.

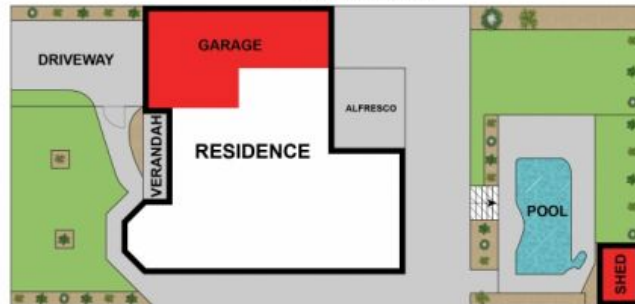
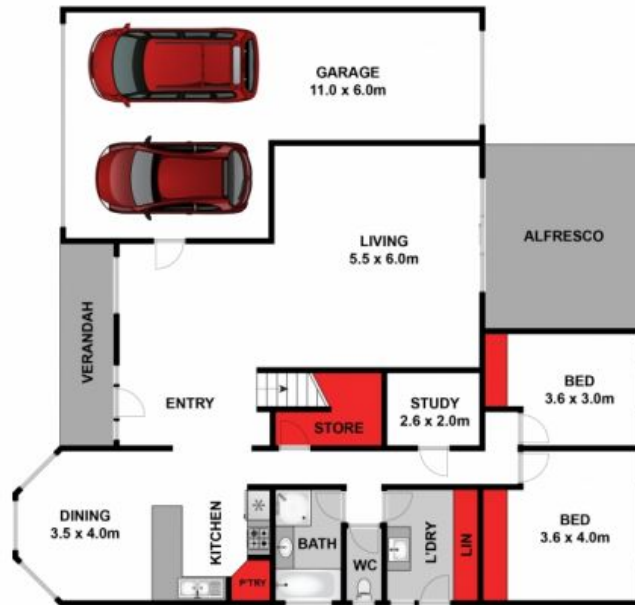

Approx House Area 304m²
Approx Land Area 684m²

Whilst bwrn.com.au has made every attempt to ensure the accuracy of the floor plan contained here, measurements are approximate and no responsibility is taken for any error, omission, or mis-statement. This plan is for illustrative purposes only.



32 Hannan Crescent, Leopold

HAYDEN

32 Hannan Crescent

LEOPOLD, VIC