



11 Parma Crescent OCEAN GROVE, VIC



4



2



2

Versatile Family Home With Coastal Views

On the high side of Parma Crescent, this easy-going, two-storey home has panoramic views of sand dunes all the way to Point Lonsdale. Entry is directly into the first of the two living spaces, with an adjacent alternate master bedroom offering direct access to the downstairs bathroom, with shower, vanity, and bath - and a separate WC. The spacious open-plan kitchen and dining area look north to a rear deck that's accessed through a sliding glass door. Overlooking the rear garden and a kids' cubby house, the deck provides a great sun trap and an ideal spot for a cruisey alfresco dinner or two. The family sized kitchen has a caesarstone return bench, Euro-style electric oven and 5-burner gas cooktop, a stainless-steel dishwasher, and twin sinks. The second bedroom has a more than generous bank of built in robes and a large window with timber venetians. Included downstairs is a versatile room with external access and would make an ideal fourth bedroom or home office for those running businesses from home. Upstairs reveals a sundrenched second living area with study nook and its own north-facing, private balcony. The upper master suite has a dreamy outlook to the sand dunes and direct access to a further bathroom. The bathroom is spacious on the floor with a walk-in-shower, spa-bath, double vanities and heated towel rail. What

Price: \$680,000 - \$740,000

Property Type: House

Land: 634 m2

HAYDEN

Lynley Bassett

0448515925

lynley@haydenoceanogrove.com.au

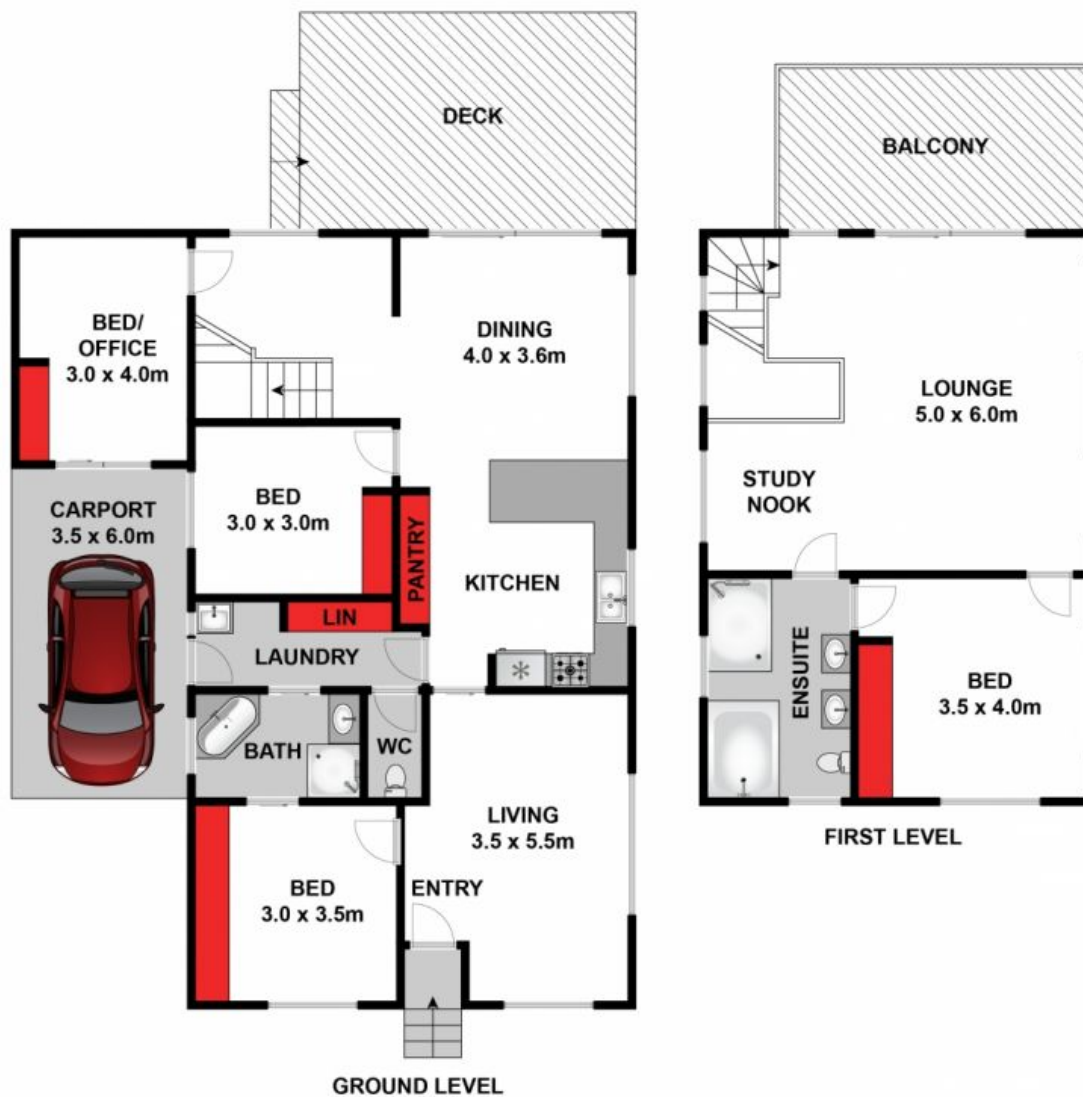

Whilst bwrn.com.au has made every attempt to ensure the accuracy of the floor plan contained here, measurements are approximate and no responsibility is taken for any error, omission, or mis-statement. This plan is for illustrative purposes only.

11 Parma Crescent, Ocean Grove

HAYDEN

11 Parma Crescent

OCEAN GROVE, VIC