



824 Bellarine Highway LEOPOLD, VIC



3



1



2

### Attention Developers/ Investors!

Occupying approx. 716m<sup>2</sup>, this property presents an excellent opportunity for first homebuyers, developers and investors.

Inside, the tidy interiors feature polished floorboards. The generous lounge unites with the north-facing porch via a glass sliding door, while the dining room is bathed in natural light. The kitchen features a breakfast bar, oven, gas hob, and rangehood.

**Price:** \$410,000 - \$450,000

**Property Type:** House

**Land:** 716 m<sup>2</sup>

# HAYDEN

Hayden Real Estate -

Leopold

samh@hayden.com.au

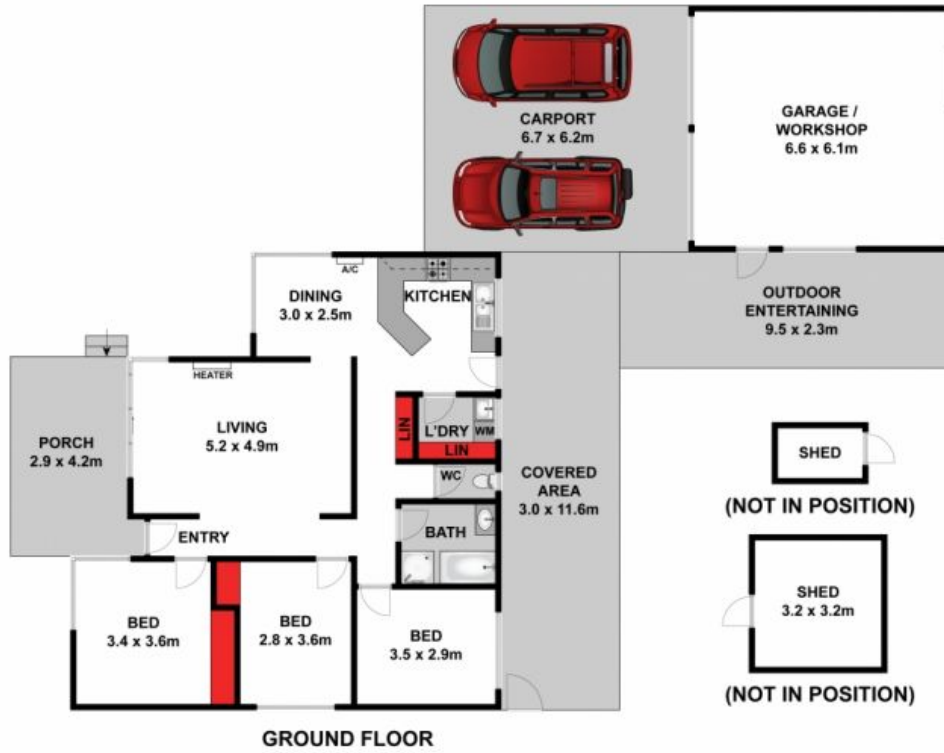

Approx House Area 102m<sup>2</sup>

Whilst [bwrn.com.au](http://bwrn.com.au) has made every attempt to ensure the accuracy of the floor plan contained here, measurements are approximate and no responsibility is taken for any error, omission, or mis-statement. This plan is for illustrative purposes only.



**824 Bellarine Highway, Leopold**

**HAYDEN**

**824 Bellarine Highway**

**LEOPOLD, VIC**