



64-66 Pollard Drive LEOPOLD, VIC



3



1



2

## The Perfect First Home Or Investment!

Occupying a corner block, this residence puts the elements in place for blissful living! Side access to the backyard also makes this an ideal choice for those looking to store caravans, boats, or trailers!

Timber laminate floorboards grace the beautifully presented interiors. The open plan living/dining/kitchen zone provides a peaceful retreat and opens onto the north-facing alfresco ? creating a beautiful setting for everyday enjoyment or casual gatherings with loved ones!

Making a stylish statement in all-white, the kitchen showcases stone benchtops, a built-in pantry, and chic pendant lighting over the breakfast bar. Stainless steel appliances include a dishwasher and 900mm oven, gas hob, canopy rangehood.

The double lock-up garage provides parking, while backyard vehicle access is ideal for additional vehicle storage.

**Price:** \$440,000 - \$480,000

**Property Type:** House

**Land:** 429 m2

# HAYDEN

**Karen Purcell**

0448510143

karenp@haydenleopold.com.au

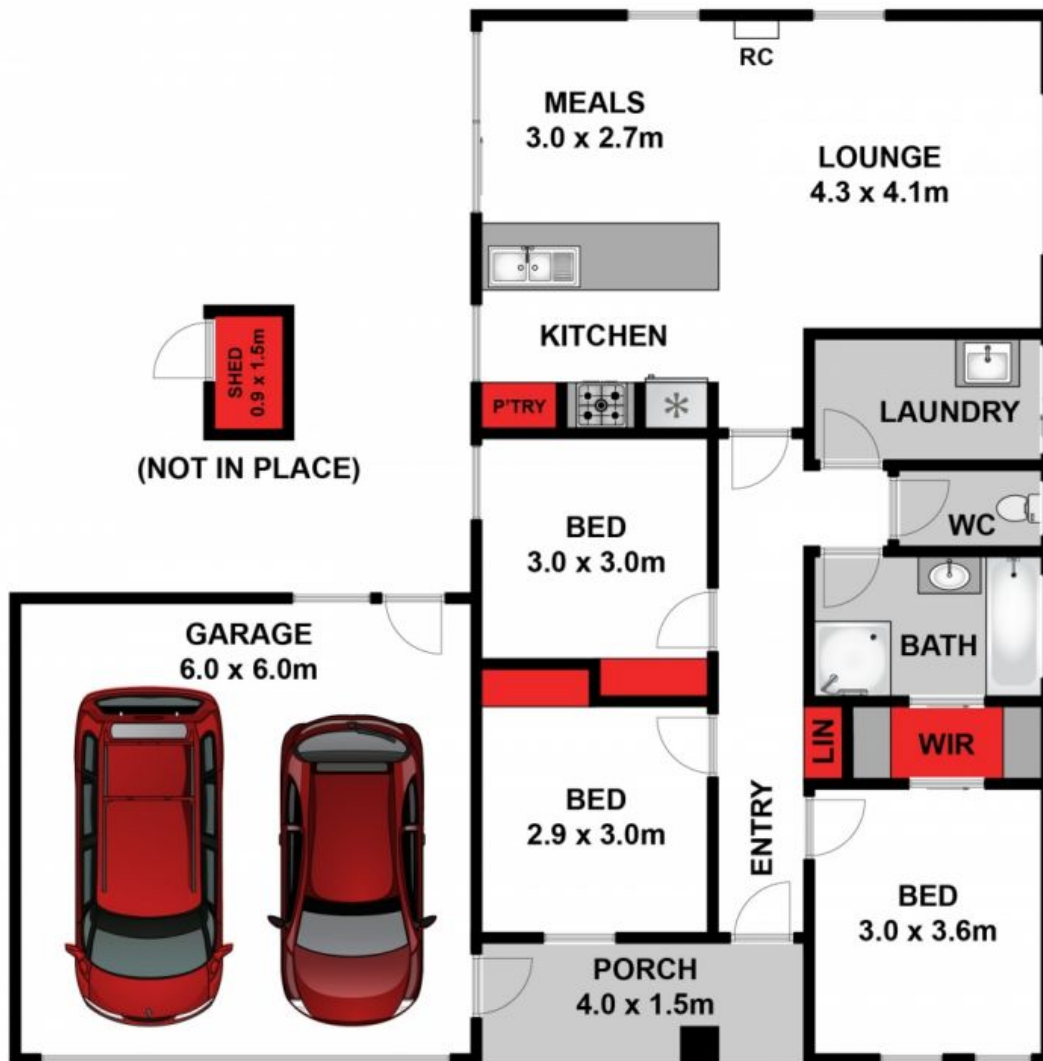

Approx House Area 136m<sup>2</sup>

Whilst [bwrn.com.au](http://bwrn.com.au) has made every attempt to ensure the accuracy of the floor plan contained here, measurements are approximate and no responsibility is taken for any error, omission, or mis-statement. This plan is for illustrative purposes only.

**64-66 Pollard Drive, Leopold**

**HAYDEN**

**64-66 Pollard Drive**

**LEOPOLD, VIC**