



DISCLAIMER: This drawing is indicative only & all measurements are approximate.



39 Highland Way LEOPOLD, VIC



5



2



2

Family Living On Half an Acre!

Occupying an impressive 2189m² (approx.) parcel of land, this home takes spacious family living to a whole new level!

Set in a peaceful pocket of Leopold, you can enjoy living within walking distance to public transport, Leopold Sportsmans Club, and the Bellarine Rail Trail. Easy access to Leopold Primary School and the Leopold Community Hub makes this an ideal location for families, while the nearby Gateway Plaza provides you with all of your shopping and dining needs. Just jump on the Portarlington Highway, and you'll soon be in the heart of Geelong or exploring the Bellarine Peninsula.

The laundry and powder room complete the lower level.

If you've been searching for spacious family living both inside and out, then this home will be at the top of your list! Inspect ASAP!

Price: \$760,000 - \$820,000

Property Type: House

Land: 2189 m²

HAYDEN

Karen Purcell

0448510143

karenp@haydenleopold.com.au

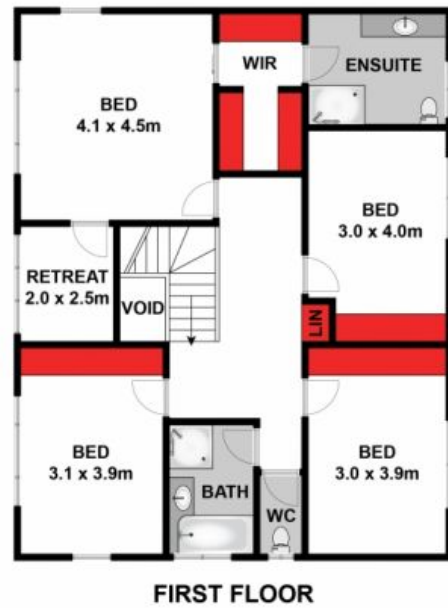
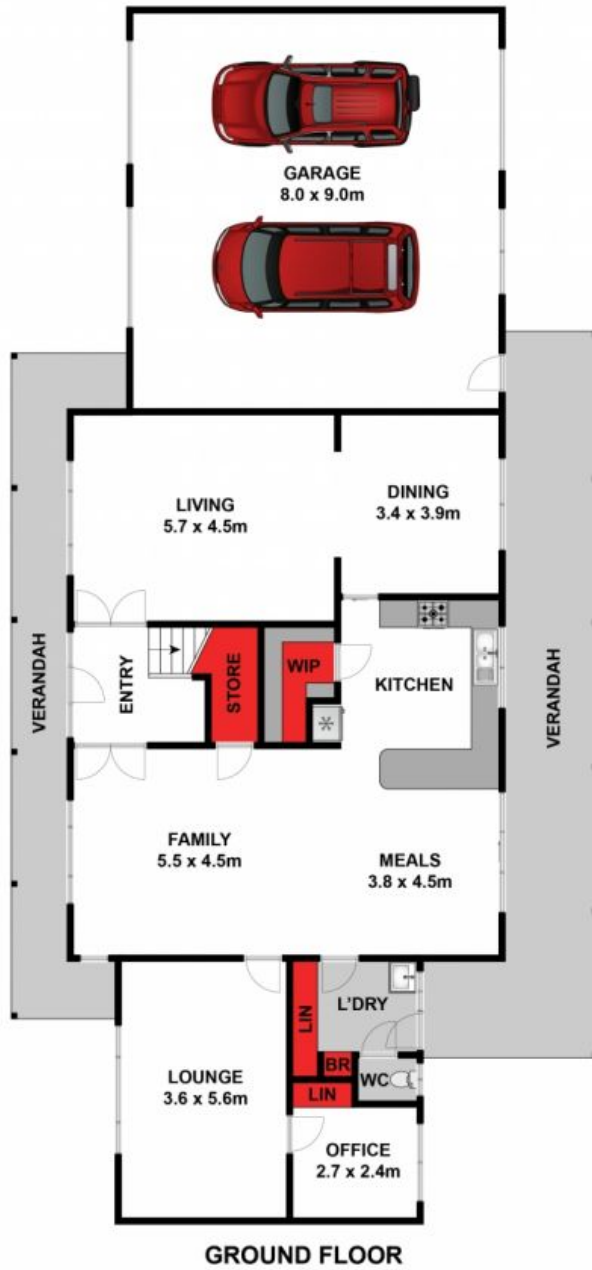

Approx House Area 336m²

Whilst bwr.com.au has made every attempt to ensure the accuracy of the floor plan contained here, measurements are approximate and no responsibility is taken for any error, omission, or mis-statement. This plan is for illustrative purposes only.

39 Highland Way, Leopold

HAYDEN

39 Highland Way

LEOPOLD, VIC