



26 Viewbay Drive LEOPOLD, VIC



6



3



4

## A Home With A Heart!

Boasting a spacious layout, north-facing bay views, and a gorgeous backyard with swimming pool, this home puts the elements in place for terrific family living!

As soon as you step inside, you'll love the sense of flow and openness this home creates. Leadlight windows grace the double door entrance, while a raked ceiling oozes character and makes a statement of the winding staircase and upper level.

The kitchen exudes elegance with stone benchtops, walk-in pantry, and quality stainless steel appliances (Miele dishwasher, SMEG 900mm oven/gas hob, Qasair rangehood). The office, bathroom, and large laundry complete the lower level.

Upstairs, the Master Bedroom is graced with a private balcony that captures views over the sparkling bay waters and You Yongs. The walk-in robe leads to the en suite, which features a single vanity, shower, and toilet. Four additional large bedrooms with built-in robes (one with window seat) share close access to the powder room and main bathroom with spa ba

**Price:** \$780,000 - \$830,000

**Property Type:** House

**Land:** 1044 m2

# HAYDEN

**Karen Purcell**

0448510143

karenp@haydenleopold.com.au

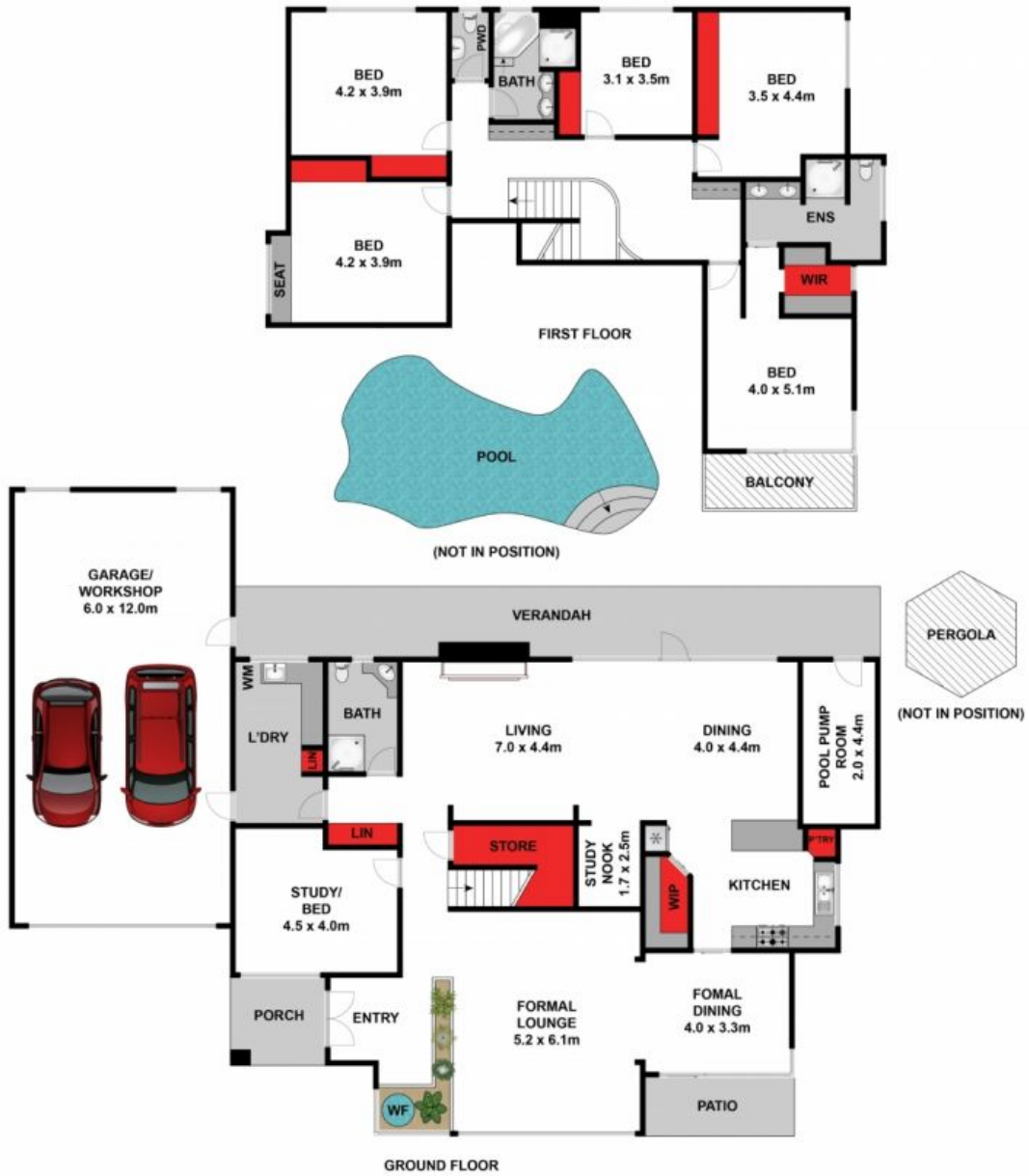

Approx House Area 416m<sup>2</sup>

Whilst [bwrn.com.au](http://bwrn.com.au) has made every attempt to ensure the accuracy of the floor plan contained here, measurements are approximate and no responsibility is taken for any error, omission, or mis-statement. This plan is for illustrative purposes only.



**26 Viewbay Drive, Leopold**

**HAYDEN**

**26 Viewbay Drive**

**LEOPOLD, VIC**