



64-66 Pollard Drive LEOPOLD, VIC



3



1



2

Modern And Bright Near New Home!

Please also note that we do not accept 1Form applications.

Price: UNDER APPLICATION

Property Type: House

Date Available: Thursday, 7th January 2021

Land: 429 m2

HAYDEN

Jenny Dries

(03) 5250 1666

jennyd@haydenoceanogrove.com.

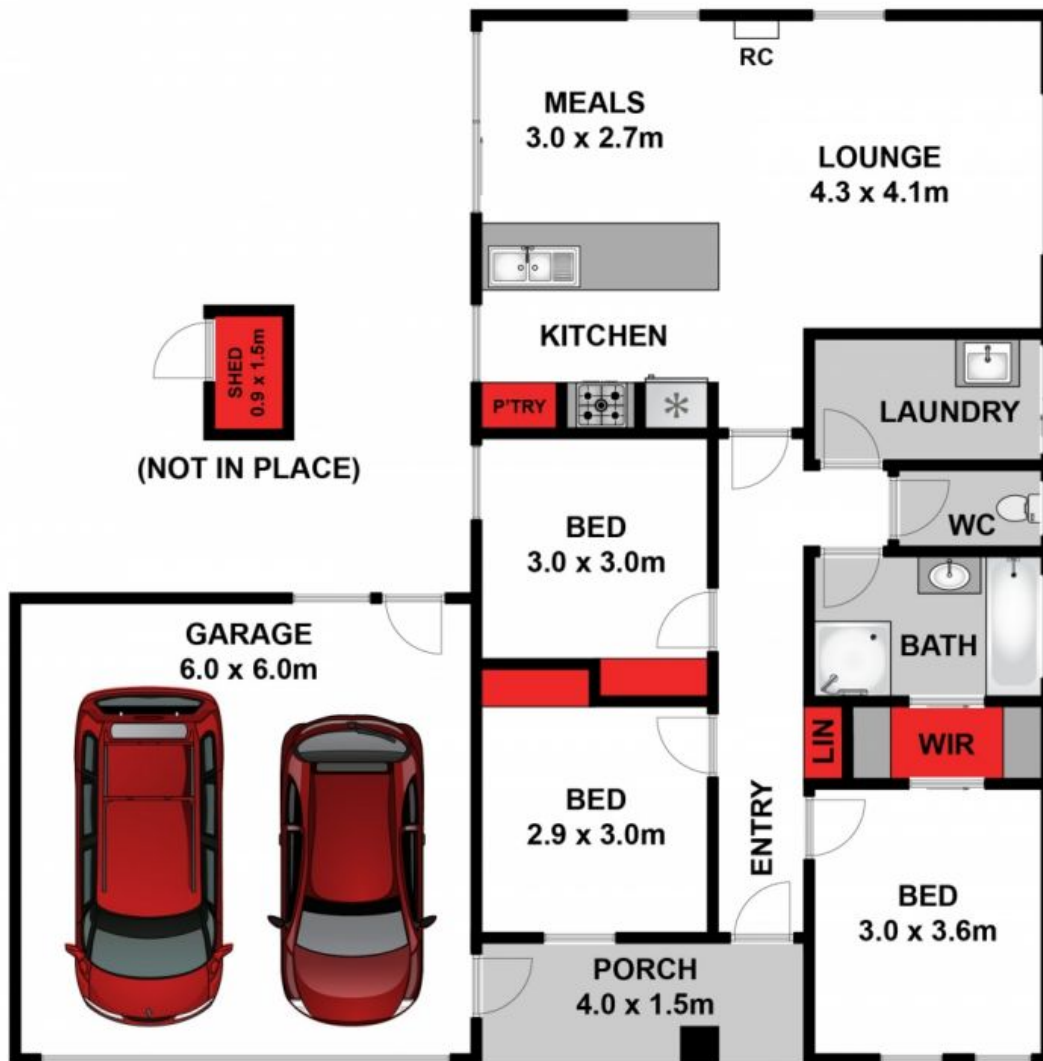

Approx House Area 136m²

Whilst bwrn.com.au has made every attempt to ensure the accuracy of the floor plan contained here, measurements are approximate and no responsibility is taken for any error, omission, or mis-statement. This plan is for illustrative purposes only.

64-66 Pollard Drive, Leopold

HAYDEN

64-66 Pollard Drive

LEOPOLD, VIC