



211-219 Swan Bay Road WALLINGTON, VIC



4



2



6

Passive Solar Design Mud Brick Home On 4.8 Acres

Bordering the McGlashan's Wallington Estate, this property presents a fantastic opportunity upon approx. 4.8 acres! Two large paddocks will instantly appeal to hobby farmers, while this superb location is ideal for setting up a bespoke restaurant or Airbnb (STCA)!

With the neighbouring vineyards surrounding the north and eastern sides of the property, you'll fall in love with this idyllic outlook - imagine entertaining loved ones in your very own backyard with a view like that!

The spacious Master Bedroom boasts external access, a walk-in robe, and en suite. Three additional bedrooms are complete with built-in robes. The generous study, main bathroom, powder room, and laundry complete the layout.

With this property, the possibilities are truly endless! Inspect without delay!

Price: \$1,100,000 - \$1,150,000

Property Type: Acreage/Semi-Rural

Land: 1.96 Hectares

HAYDEN

Karen Purcell

0448510143

karenp@haydenleopold.com.au

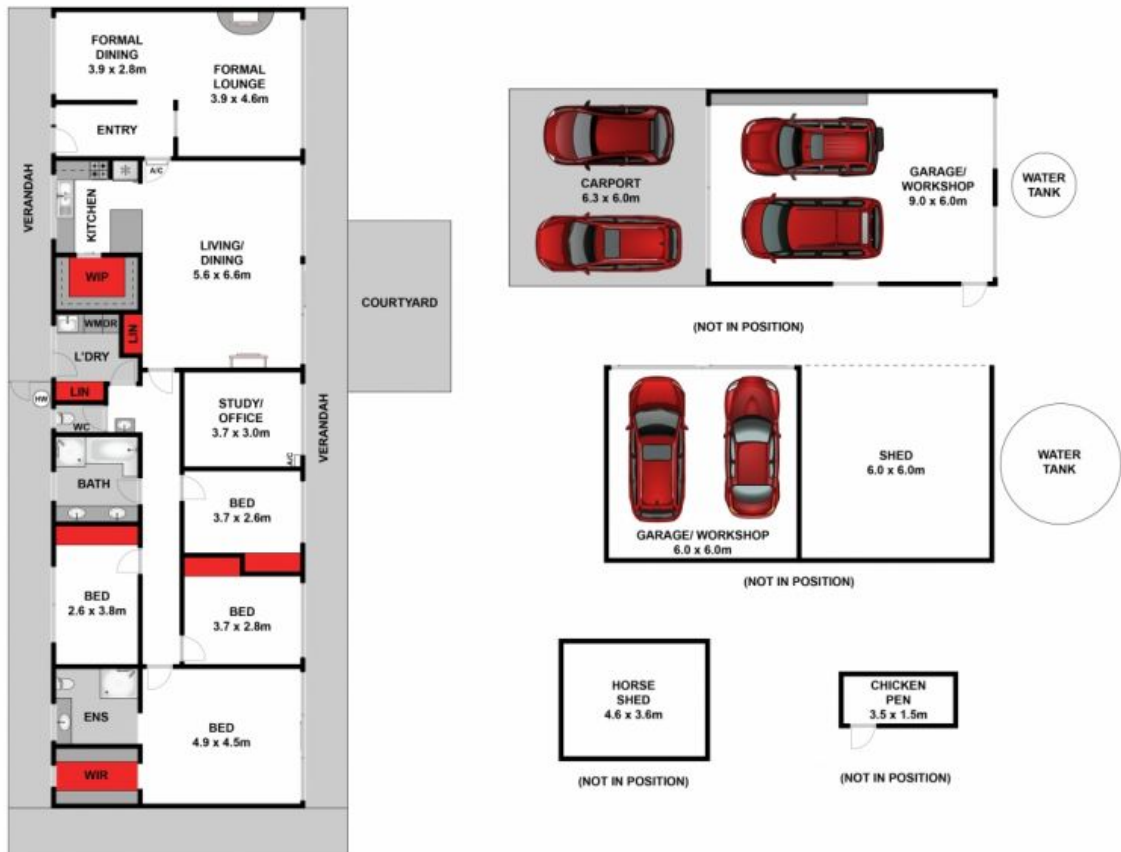

GROUND FLOOR

SITE PLAN

Approx House Area 202m²
Approx Land Area 17,755m²

Whilst bwrn.com.au has made every attempt to ensure the accuracy of the floor plan contained here, measurements are approximate and no responsibility is taken for any error, omission, or mis-statement. This plan is for illustrative purposes only.



215 Swan Bay Road, Wallington

HAYDEN

211-219 Swan Bay Road

WALLINGTON, VIC