

6A Arabando Drive LEOPOLD, VIC



3



1



1

## A Hidden Gem In A Convenient Locale!

Sitting proudly on its own title, this property promises easy living on approx. 643m<sup>2</sup>! The kitchen, bathroom, and laundry have all been beautifully renovated within the last year. Plus, the north-facing backyard will delight those who are seeking low-maintenance living without compromising on outdoor space!

Inside, the interiors are in immaculate condition. Both the lounge and living area unite with the dining/kitchen zone, creating a sense of flow throughout the lower level. With the lounge opening onto the wrap-around deck, you'll love that you can enjoy a cup of tea while overlooking the backyard.

The laundry and separate toilet complete the lower level.

With two of the bedrooms boasting west-facing views, you'll love soaking up the lights over Geelong at night.

Two split-system air conditioners and a ceiling fan provide modern comfort. The easy-care gardens leave you free to enjoy the more important things in life, while the fake timber d

**Price:** \$475,000 - \$495,000

**Property Type:** House

**Land:** 643 m<sup>2</sup>

# HAYDEN

**Karen Purcell**

0448510143

karenp@haydenleopold.com.au

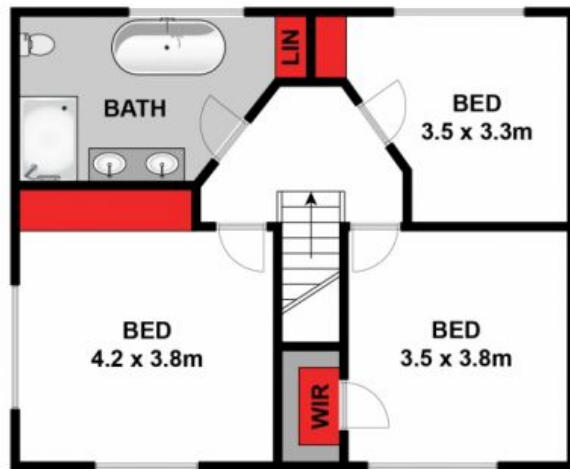

LEVEL ONE

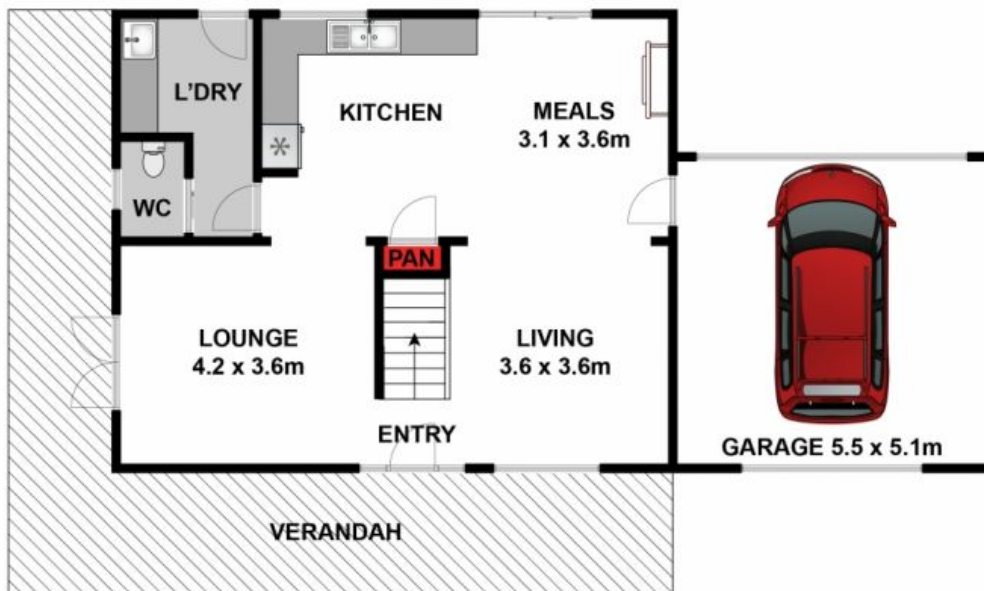

GROUND FLOOR

Approx House Area 96m<sup>2</sup>

Whilst [bwrn.com.au](http://bwrn.com.au) has made every attempt to ensure the accuracy of the floor plan contained here, measurements are approximate and no responsibility is taken for any error, omission, or mis-statement. This plan is for illustrative purposes only.

6 Arabando Drive, Leopold

**HAYDEN**

6A Arabando Drive

LEOPOLD, VIC