



1 Vinci Place LEOPOLD, VIC



4



2



4

Stylish Family Residence With Large Work Shed!

Occupying approx. 720m², every inch of this family residence will astound! The quality interiors exude on-trend style, while vehicle access to the rear work shed will impress tradies!

Ideally positioned in a quiet cul de sac, this location places you footsteps away from the Bellarine Rail Trail. Leopold Primary School and the Leopold Community Hub are within close reach, along with the Gateway Plaza and local sporting grounds. The Portarlington Highway grants easy access to the delights of both Geelong and the Bellarine Peninsula.

Approx. five years old, you'll love that this home feels brand sparkling new. High, square-set ceilings enhance the sleek interiors, along with porcelain floor tiles and tall doorframes. The open plan living/dining/kitchen zone creates a central retreat for the whole family to enjoy, while opening onto the sheltered alfresco for effortless entertaining options. The family room is ideal for children and teens, while the front lounge provides a cal

Price: \$690,000 - \$750,000

Property Type: House

Land: 720 m²

HAYDEN

Karen Purcell

0448510143

karenp@haydenleopold.com.au

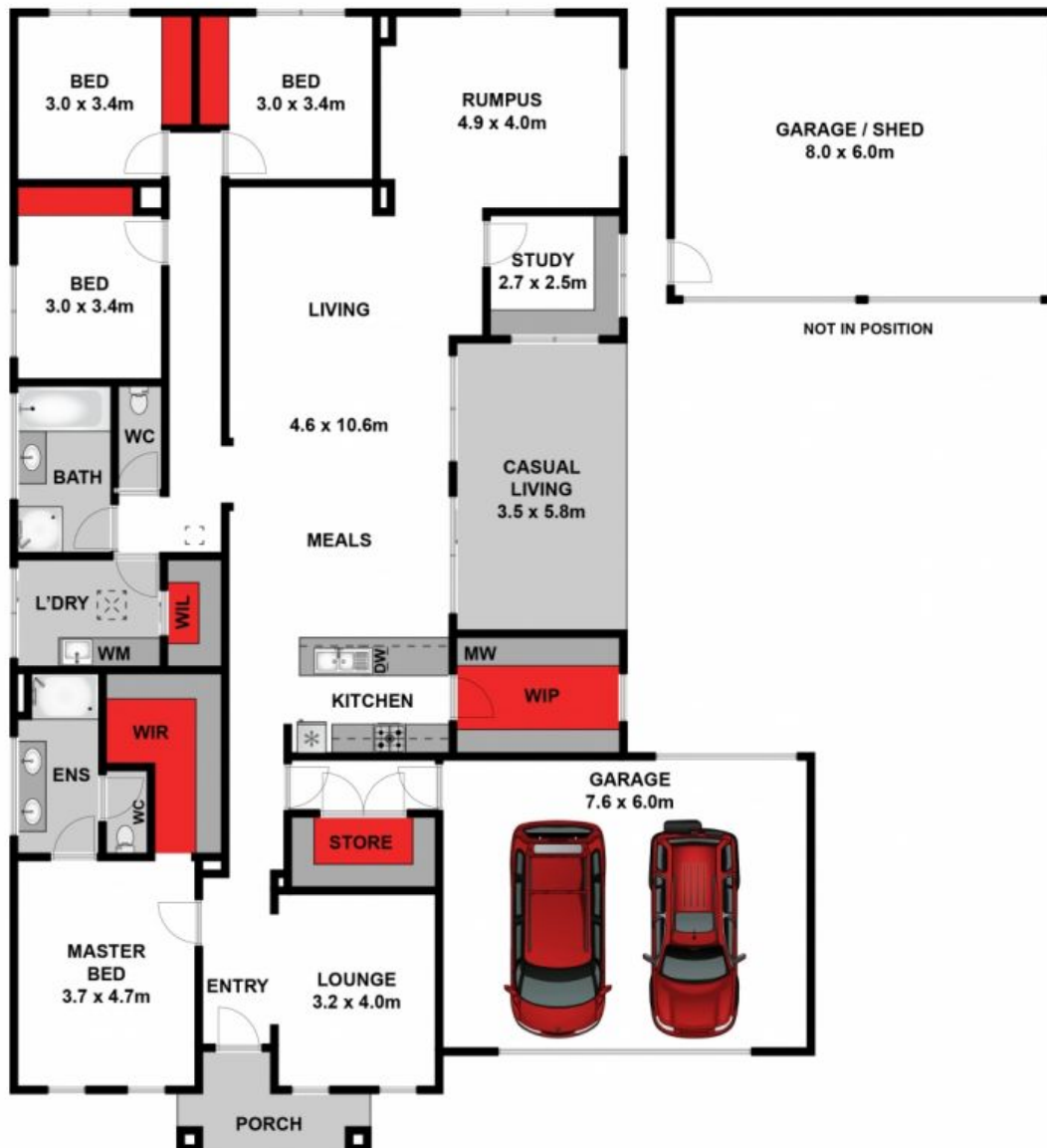

Approx House Area 292m²

Whilst bwrn.com.au has made every attempt to ensure the accuracy of the floor plan contained here, measurements are approximate and no responsibility is taken for any error, omission, or mis-statement. This plan is for illustrative purposes only.

1 Vinci Place, Leopold

HAYDEN

1 Vinci Place

LEOPOLD, VIC