



Approx Unit 1 Area 125m<sup>2</sup>  
 Approx Unit 2 Area 122m<sup>2</sup>  
 Approx Land Area 842m<sup>2</sup>

Whilst [benm.com.au](http://benm.com.au) has made every attempt to ensure the accuracy of the floor plan contained here, measurements are approximate and no responsibility is taken for any error, omission, or mis-statement. This plan is for illustrative purposes only.



## 16 Viewbay Drive, Leopold

**HAYDEN**



1 & 2/16 Viewbay Drive LEOPOLD, VIC



6



2



2

### Private Inspections Available

A Rare Opportunity to Secure Two Units On One Title!

Presenting two units upon a spacious 842m<sup>2</sup> (approx.) block, this is the ultimate investment opportunity! Whether you plan to lease both homes, or to live in one while you lease the other, this is an opening not to be missed. This property also offers an ideal set-up for those with family members who enjoy their independence but still need to be close to the primary caregivers.

In the front unit, a split-system air conditioner and ceiling fans provide modern comfort. The secure backyard will delight with gorgeous gardens and a veggie/herb patch. The small alfresco features a café blind to protect from the elements - meaning you can enjoy this beautiful outdoor setting all year long. The remote single lock-up garage provides secure

**Price:** \$740,000 - \$760,000

**Property Type:** Unit

**Land:** 842 m<sup>2</sup>

**HAYDEN**

**Karen Purcell**

0448510143

[karenp@haydenleopold.com.au](mailto:karenp@haydenleopold.com.au)

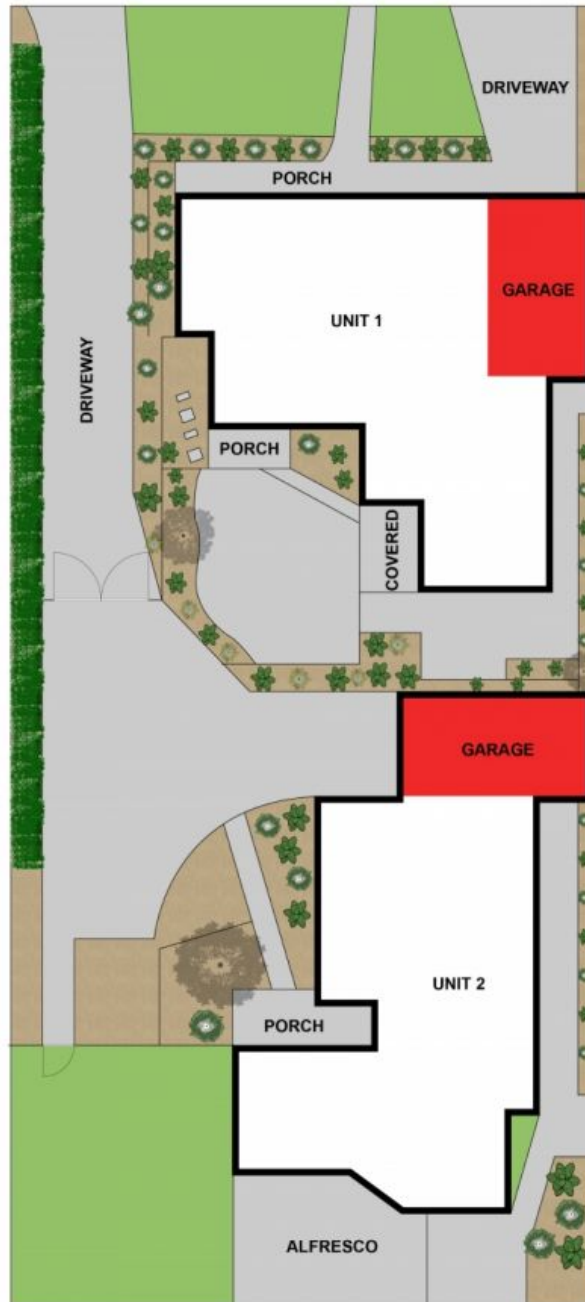

Approx Unit 1 Area 125m<sup>2</sup>  
 Approx Unit 2 Area 122m<sup>2</sup>  
 Approx Land Area 842m<sup>2</sup>

Whilst [bwrn.com.au](http://bwrn.com.au) has made every attempt to ensure the accuracy of the floor plan contained here, measurements are approximate and no responsibility is taken for any error, omission, or mis-statement. This plan is for illustrative purposes only.



**16 Viewbay Drive, Leopold**

**HAYDEN**

**1 & 2/16 Viewbay Drive**

**LEOPOLD, VIC**