



1-3 Beacon Point Road CLIFTON SPRINGS, VIC



4



2



2

## Soak in the Calm in Clifton Springs

For as far as the eye can see there is a view from this property, the last home before the water's edge in Clifton Springs called, Beacon House. Whether it be across Port Phillip Bay to the You Yangs, over the top of towering gums or Melbourne's city skyline - the panoramic outlook is like nothing else!

If that is not enough to tempt you, this double-storey residence on a large allotment exudes on trend 1970s charm with cathedral ceilings, split levels, timber trimmings and a sunken lounge.

The second level presents as a self-contained unit with a kitchenette, recently renovated bathroom, living and meals area, fourth bedroom and walk-in dressing robe. As well as an enclosed balcony that functions as a sunroom. Here is an opportunity to tap into holiday ma

**Price:** \$1,100,000 - \$1,200,000

**Property Type:** House

**Land:** 1281 m2

# HAYDEN

**Penny Dawson**

0448510200

penny@haydenoceanogrove.com.



GROUND FLOOR



FIRST FLOOR

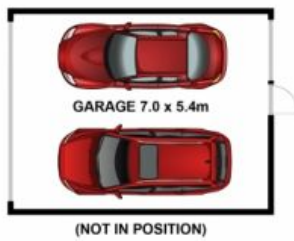

(NOT IN POSITION)

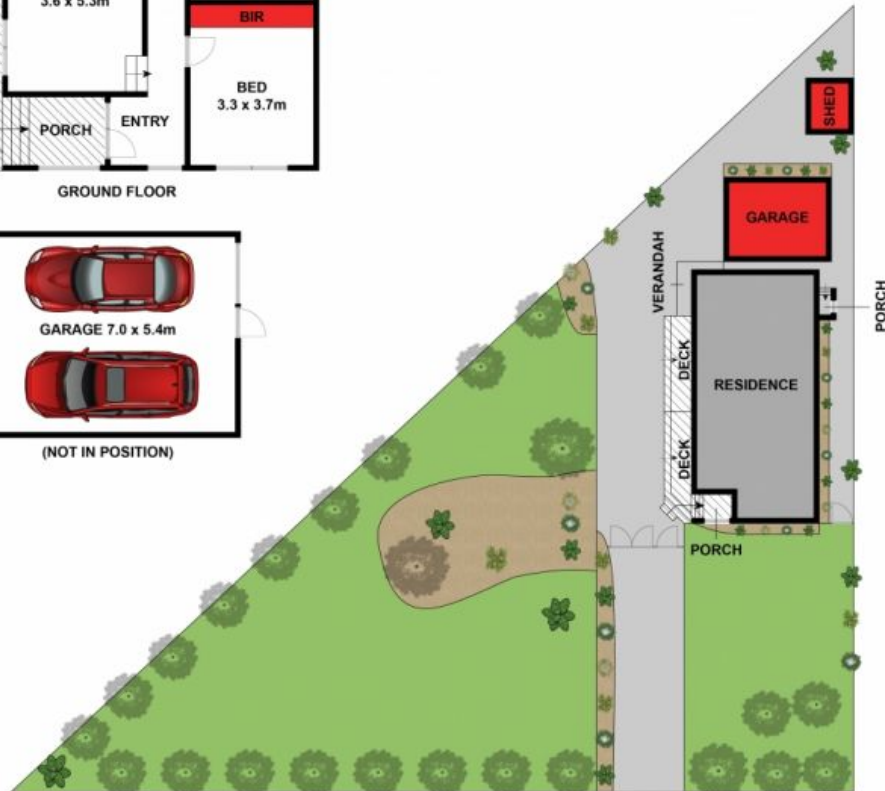

Whilst [bwrn.com.au](http://bwrn.com.au) has made every attempt to ensure the accuracy of the floor plan contained here, measurements are approximate and no responsibility is taken for any error, omission, or mis-statement. This plan is for illustrative purposes only.



1-3 Beacon Point Road, Clifton Springs

**HAYDEN**

1-3 Beacon Point Road

CLIFTON SPRINGS, VIC