



19 Morrow Crescent LEOPOLD, VIC



3



2



2

Private Inspections Available

Easy Living With A North-Facing Yard & Caravan Storage!

Whether you're dreaming of owning your own home, searching for a terrific investment, or on the hunt for the perfect downsizer, this home will be at the top of your list! Featuring a north-facing backyard and secure storage space for a caravan or boat, this home is simply charming!

The Master Bedroom overlooks the backyard, with the walk-in robe leading through to the en suite. Two additional bedrooms with built-in robes share close access to main bathroom, while the separate toilet and laundry with external access complete the layout. Modcons include ducted heating, two split-system air conditioners, and ducted vacuum. Established gardens surround the backyard, which is also home to lush lawn and a garden shed. 3KW of solar panels benefits both the environment and your bank account, while a veggie garden and 2

Price: \$495,000 - \$535,000
Property Type: House
Land: 501 m2

HAYDEN

Karen Purcell

0448510143

karenp@haydenleopold.com.au

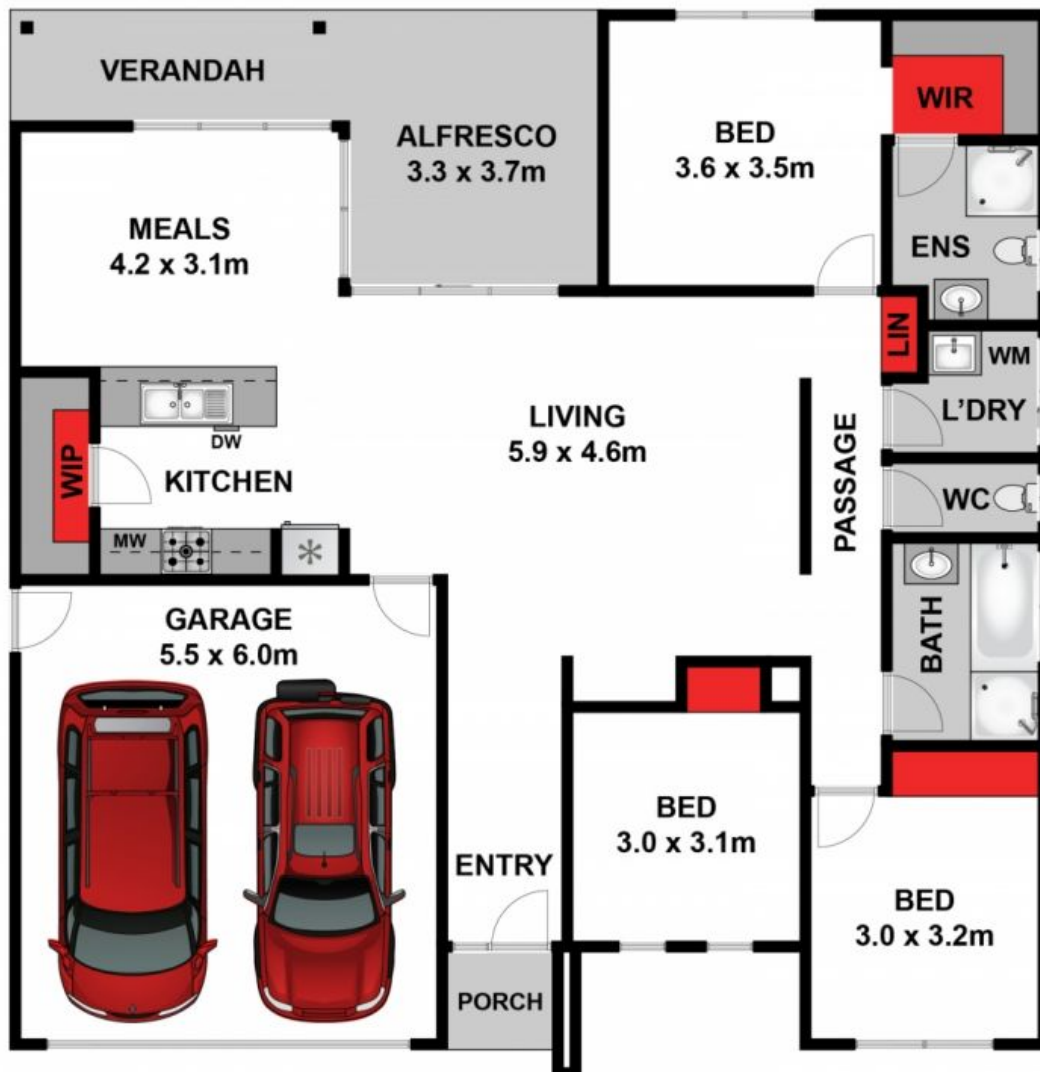

Approx House Area 160m²

Whilst bwrn.com.au has made every attempt to ensure the accuracy of the floor plan contained here, measurements are approximate and no responsibility is taken for any error, omission, or mis-statement. This plan is for illustrative purposes only.

19 Morrow Crescent, Leopold

HAYDEN

19 Morrow Crescent

LEOPOLD, VIC