



2/2 Park Lane TORQUAY, VIC



3



1



1

Sun, Sea and Sand

Private Inspections Welcome - By Appointment Only

With the ocean almost in your back garden and spectacular views, it cannot get any better than this. Park Lane is a premium address and properties here are rarely available. This is an exciting opportunity to be one of the lucky few to enjoy such a sought after spot. The low maintenance, two-storey townhouse offers effortless beachside living, which is perfect for permanent or holiday home buyers as well as investors.

Price: \$1,100,000 - \$1,200,000

Property Type: Townhouse

HAYDEN

Hayden Real Estate **Bryan Hayden**

0417613250

Torquay

samh@hayden.com.au

bryanh@hayden.com.au

2/2 PARK LANE, TORQUAY

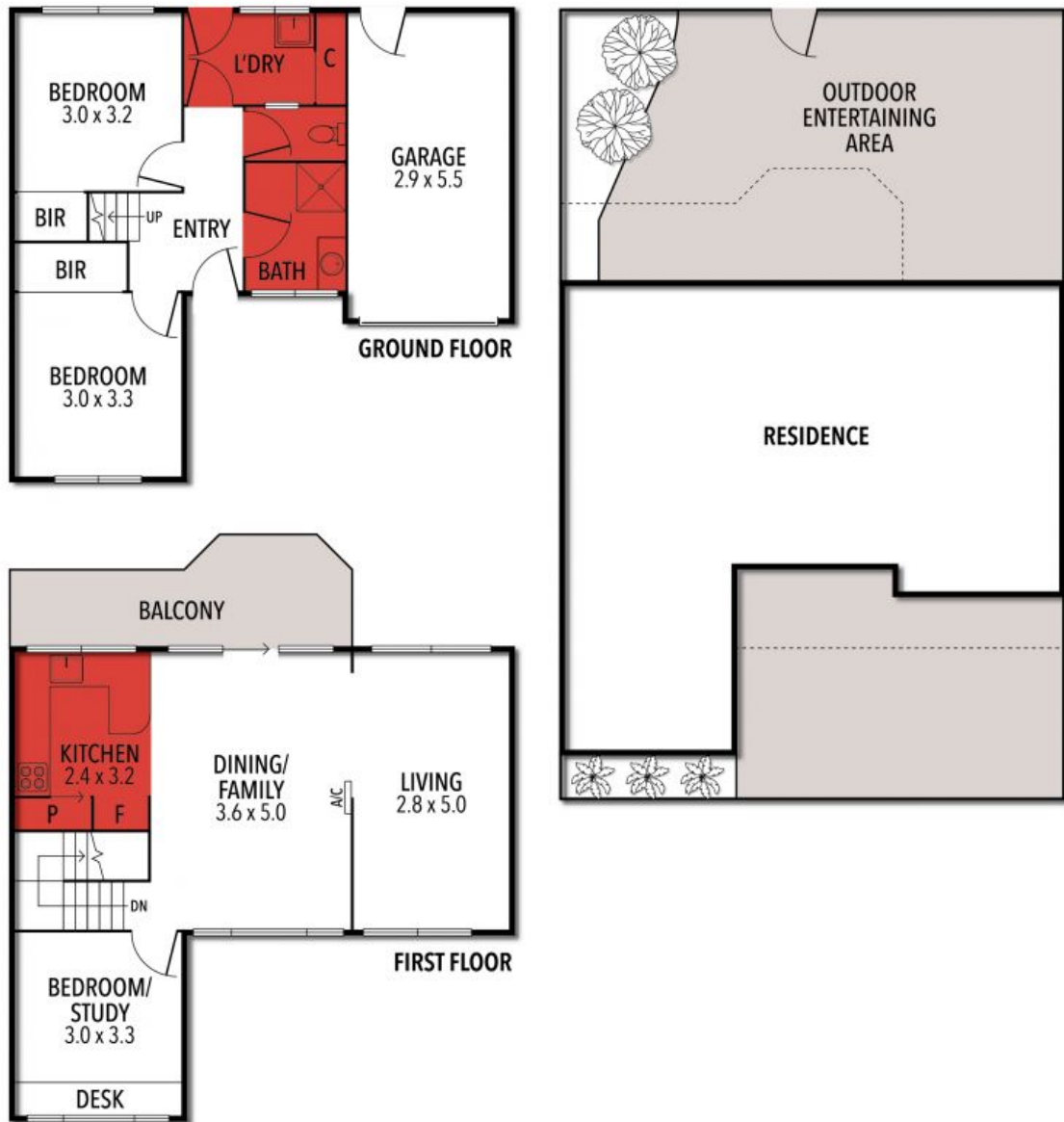

THE ABOVE PLAN IS AN ARTIST'S IMPRESSION ONLY, IT INCLUDES ELEMENTS THAT ARE FOR DISPLAY PURPOSES ONLY AND MAY NOT BE TO SCALE. LANDSCAPING SHOWN IS INDICATIVE ONLY. DIMENSIONS ARE APPROXIMATE.