



26 Cornthwaite Crescent LEOPOLD, VIC



3



2



1

Spacious Living, Both Inside and Out!

Set upon approx. 665m², this property offers spacious family living both inside and out!

Outside, the alfresco creates a peaceful setting for outdoor living. Leafy trees create a lovely sense of privacy. The backyard gives children plenty of room to run and play, while the gardens are home to a veggie box. The remote single lock-up garage is complete with a workshop.

Price: \$495,000 - \$540,000

Property Type: House

Land: 665 m²

HAYDEN

Karen Purcell

0448510143

karenp@haydenleopold.com.au

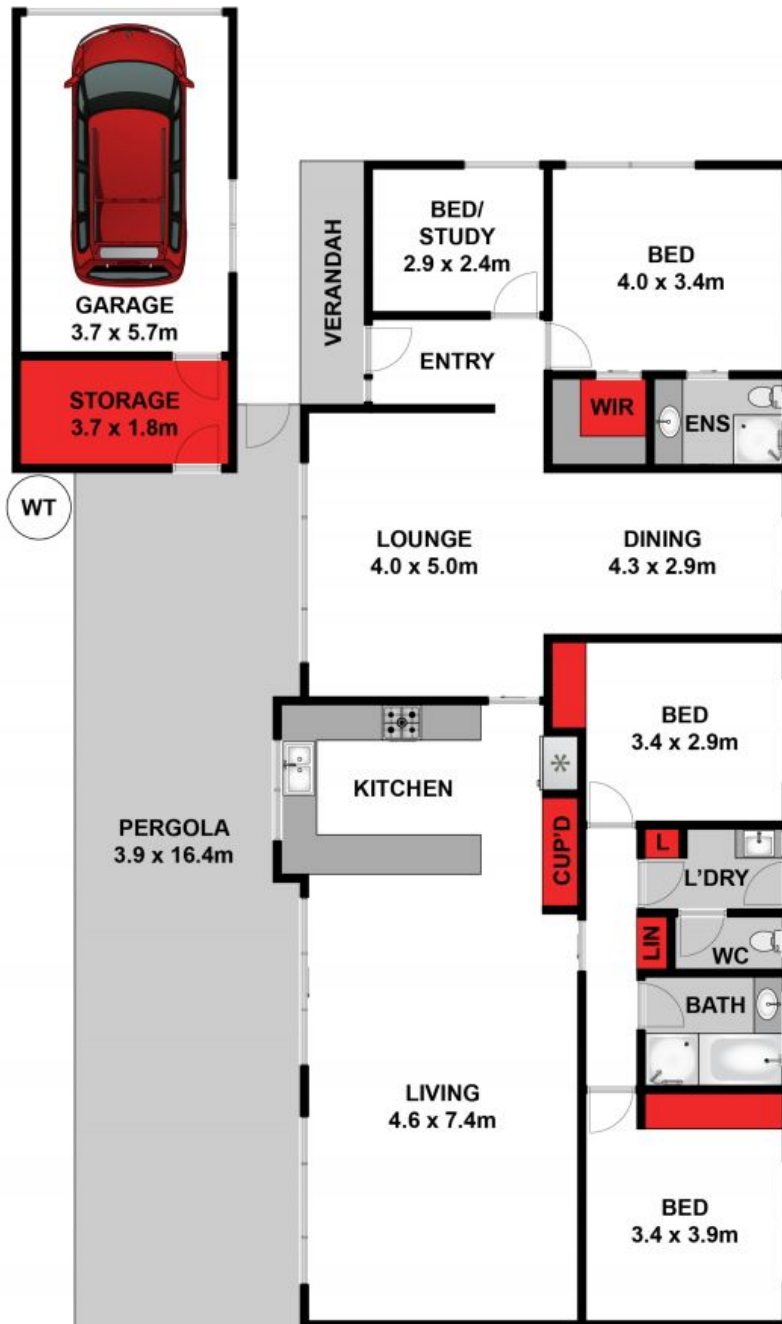

Approx House Area 162m²

Whilst bwrn.com.au has made every attempt to ensure the accuracy of the floor plan contained here, measurements are approximate and no responsibility is taken for any error, omission, or mis-statement. This plan is for illustrative purposes only.



26 Cornthwaite Crescent, Leopold

HAYDEN

26 Cornthwaite Crescent

LEOPOLD, VIC