



1 & 2/25 Everist Road OCEAN GROVE, VIC

Commercial Investment Opportunity In Industrial Zone

Ocean Grove is a growing, highly-sought after coastal town on the Bellarine Peninsula. Over the past couple of years, the town's industrial zone has been transformed into a diverse, bustling commercial precinct, and for businesses that require warehouses with/without office space this is the ultimate position to be based. Call Hugh to arrange an inspection to see the potential for yourself.

Price: \$900,000 - \$990,000

Property Type: Industrial

Land: 1200 m2

HAYDEN

Hugh McKewan

0417538779

hugh@haydenoceanrove.com.au

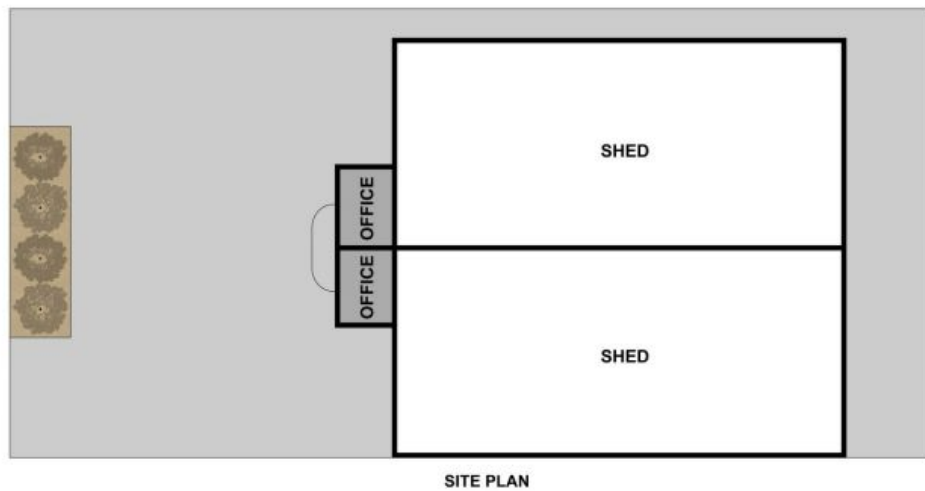
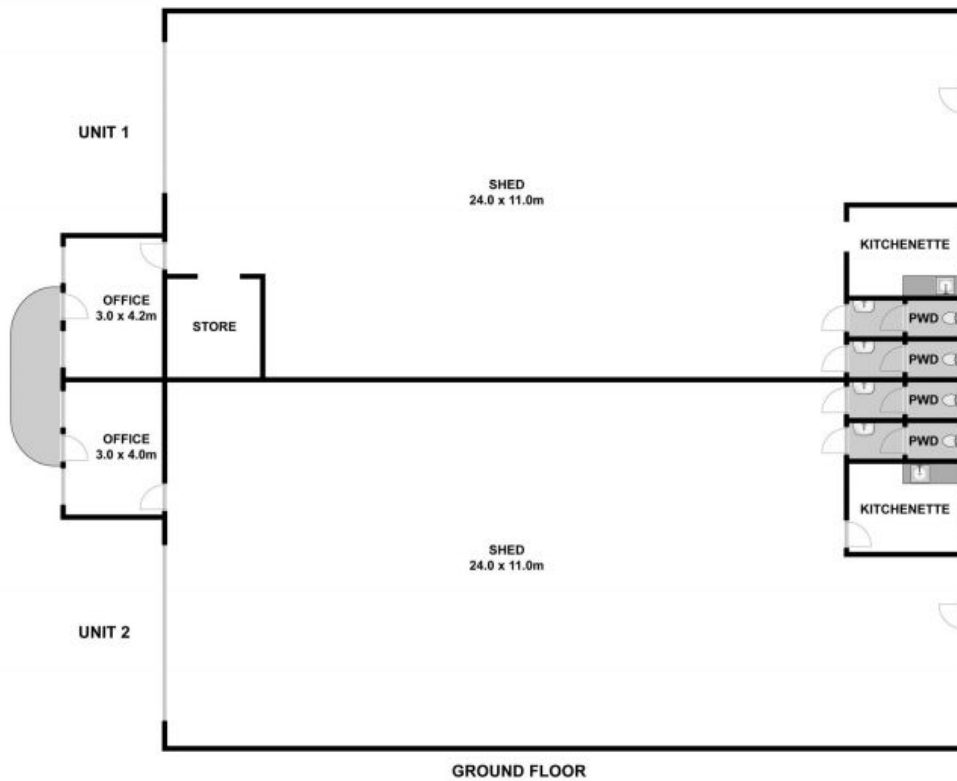

Whilst bwrn.com.au has made every attempt to ensure the accuracy of the floor plan contained here, measurements are approximate and no responsibility is taken for any error, omission, or mis-statement. This plan is for illustrative purposes only.



Units 1 & 2, 25 Everist Road, Ocean Grove



1 & 2/25 Everist Road

OCEAN GROVE, VIC