



9 Arabando Drive LEOPOLD, VIC



3



2



2

Spacious Family Living In A Superb Location!

Set upon approx. 708m², this home presents an ideal choice for families and investors alike!

The Master Bedroom features a walk-in robe and en suite. Two additional bedrooms with built-in robes are located at the rear of the home, along with the main bathroom and separate toilet. The laundry boasts external access. You'll be in comfort all year long thanks to a gas wall heater, air conditioner and ceiling fans.

Price: \$510,000 - \$550,000

Property Type: House

Land: 708 m²

HAYDEN

Karen Purcell

0448510143

karenp@haydenleopold.com.au

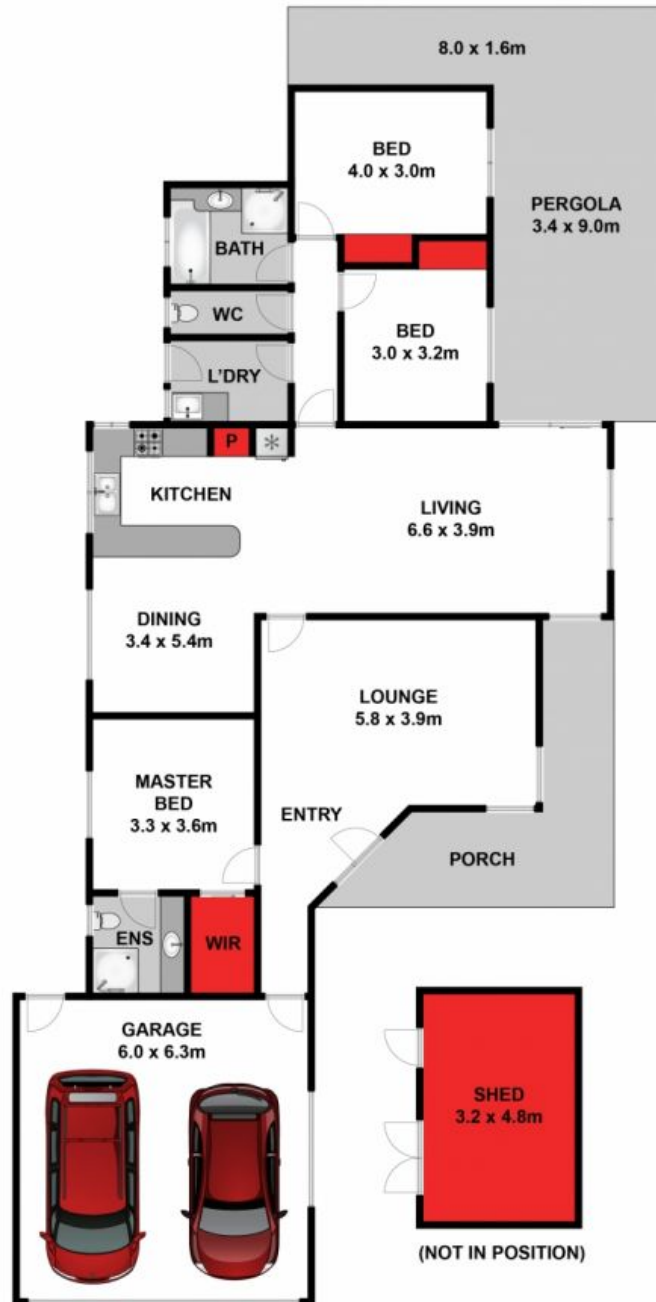

Approx House Area 187m²

Whilst bwrn.com.au has made every attempt to ensure the accuracy of the floor plan contained here, measurements are approximate and no responsibility is taken for any error, omission, or mis-statement. This plan is for illustrative purposes only.



9 Arabando Drive, Leopold

HAYDEN

9 Arabando Drive

LEOPOLD, VIC