



25 Yeoman Crescent LEOPOLD, VIC



4



2



2

## The Perfect Package For Modern Families!

Treat your family to the lifestyle you've been craving in Leopold! Set upon approx. 643m<sup>2</sup>, this home will delight with a spacious backyard and a remote double lock-up garage that boasts rear vehicle access!

With the local parkland and playground just three doors down, this is an ideal location for young families. Public transport and the Bellarine Rail Trail are a short stroll away, while Leopold P.S. and the Gateway Plaza are conveniently close by. Superior access to the Portarlington Highway keeps you connected to both Geelong and the Bellarine Peninsula.

With the interiors in immaculate condition, there's nothing left to do except move in and enjoy. The front lounge entices you to relax, while the open plan living/dining/kitchen zone creates a generous setting that is perfect for the modern family. With large windows overlooking the lush backyard, you'll love that this main living zone is bathed in natural light. The kitchen takes care of all your cooking needs with a built-in pantry and stainless

**Price:** \$540,000 - \$580,000

**Property Type:** House

**Land:** 643 m<sup>2</sup>

# HAYDEN

**Karen Purcell**

0448510143

karenp@haydenleopold.com.au

**Robyn Grumley**

0448510134

robyn@haydenleopold.com.au

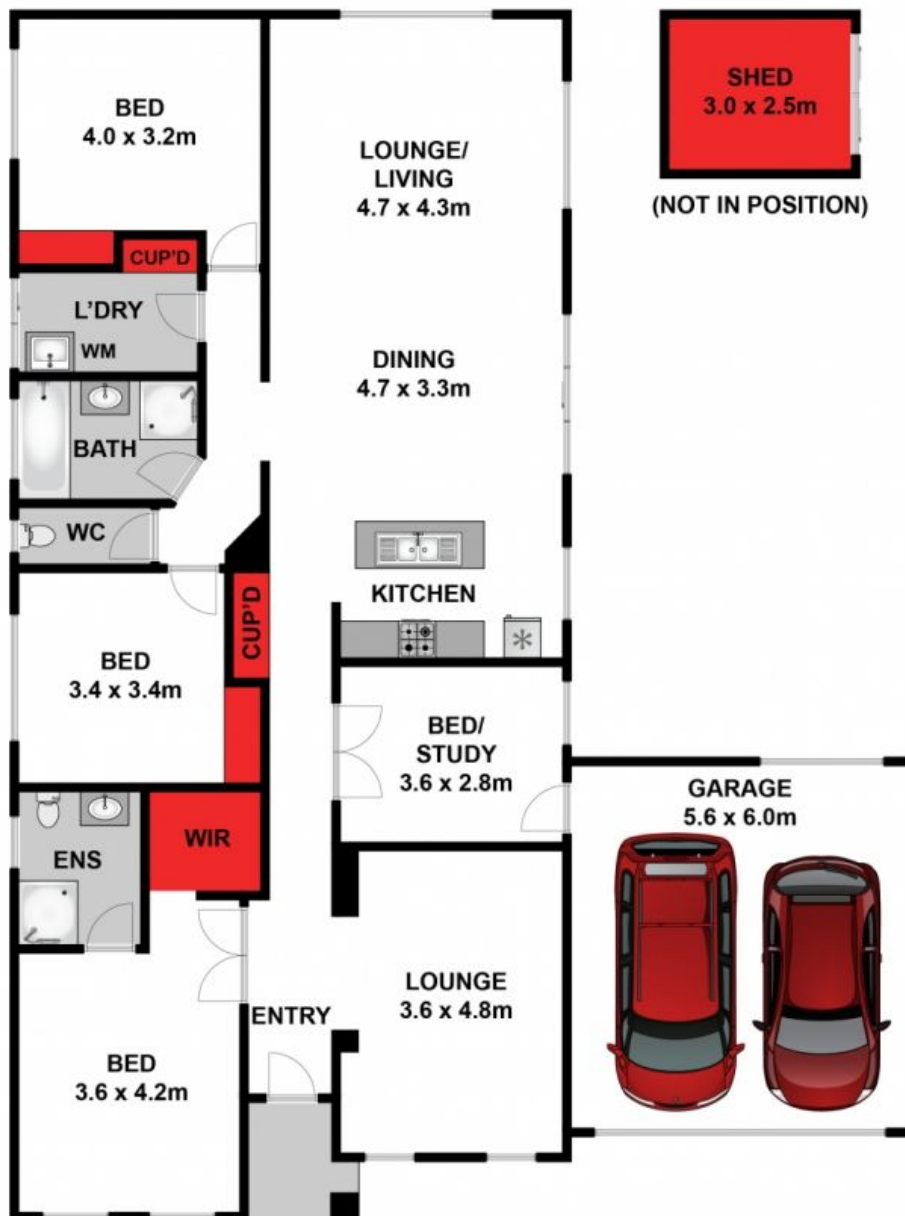

Approx House Area 204m<sup>2</sup>

Whilst [bwr.com.au](http://bwr.com.au) has made every attempt to ensure the accuracy of the floor plan contained here, measurements are approximate and no responsibility is taken for any error, omission, or mis-statement. This plan is for illustrative purposes only.



25 Yeoman Crescent, Leopold

**HAYDEN**

25 Yeoman Crescent

LEOPOLD, VIC