



8 Parkfront Drive LEOPOLD, VIC



4



2



2

## Abode For The Growing Family!

If you've been searching for easy family living in a terrific location, then this is the one for you! This low-maintenance home offers plenty of space for the growing family, while the location promises to upgrade your lifestyle in an instant!

**Price:** \$510,000 - \$560,000

**Property Type:** House

**Land:** 400 m2

Whether you're dreaming of owning your own home or simply looking for a great location to raise your family, this will be at the top of your list! Inspect ASAP!

# HAYDEN

**Karen Purcell**

0448510143

karenp@haydenleopold.com.au

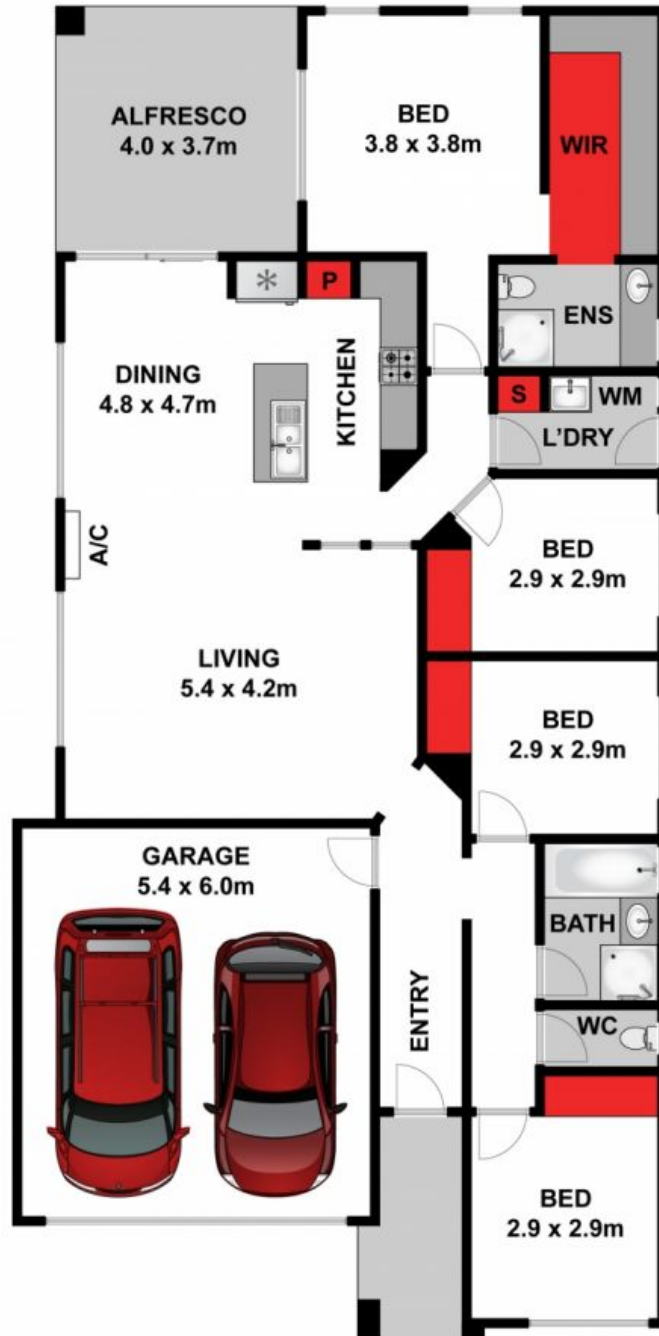

Approx House Area 171m<sup>2</sup>

Whilst [bwrn.com.au](http://bwrn.com.au) has made every attempt to ensure the accuracy of the floor plan contained here, measurements are approximate and no responsibility is taken for any error, omission, or mis-statement. This plan is for illustrative purposes only.



**8 Parkfront Drive, Leopold**

**HAYDEN**

**8 Parkfront Drive**

**LEOPOLD, VIC**