



8 Parkfront Drive LEOPOLD, VIC



4



2



2

Abode For The Growing Family!

If you've been searching for easy family living in a terrific location, then this is the one for you! This low-maintenance home offers plenty of space for the growing family, while the location promises to upgrade your lifestyle in an instant!

Price: \$510,000 - \$560,000

Property Type: House

Land: 400 m2

Whether you're dreaming of owning your own home or simply looking for a great location to raise your family, this will be at the top of your list! Inspect ASAP!

HAYDEN

Karen Purcell

0448510143

karenp@haydenleopold.com.au

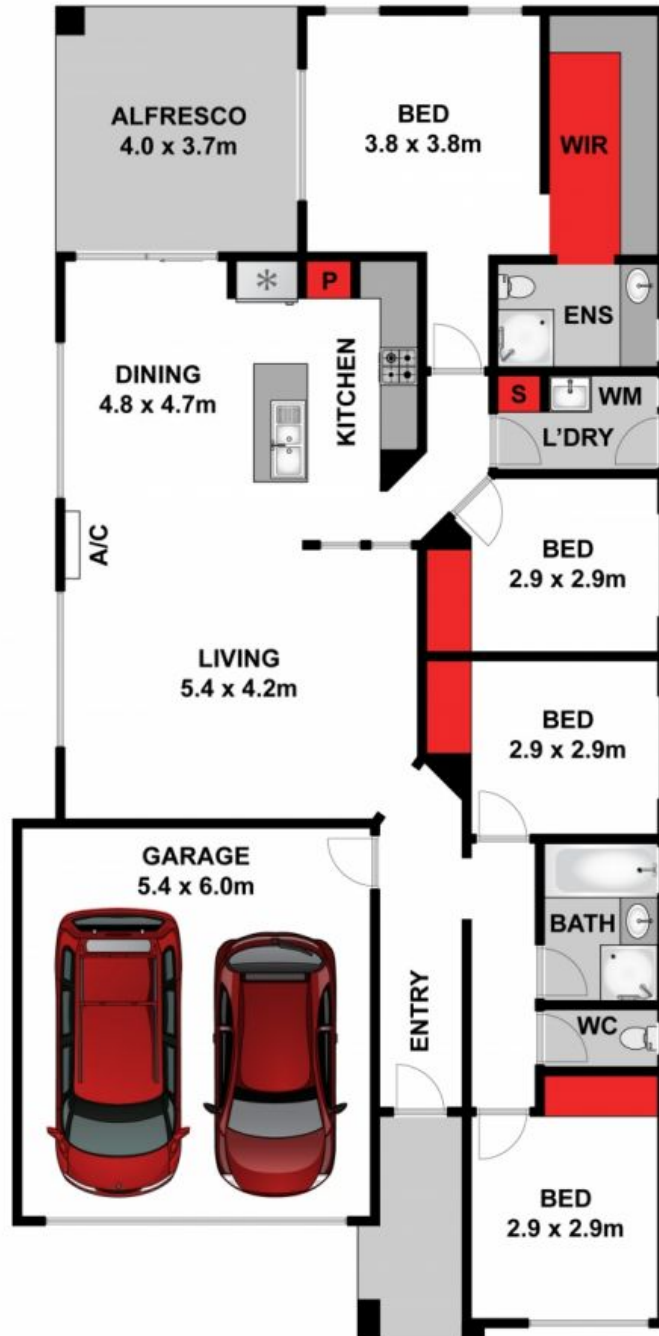

Approx House Area 171m²

Whilst bwrn.com.au has made every attempt to ensure the accuracy of the floor plan contained here, measurements are approximate and no responsibility is taken for any error, omission, or mis-statement. This plan is for illustrative purposes only.



8 Parkfront Drive, Leopold

HAYDEN

8 Parkfront Drive

LEOPOLD, VIC