



34 Hazelwood Crescent LEOPOLD, VIC



4



2



2

## UNDER CONTRACT

Have you been searching for spacious family living? Boasting a flexible layout and ample off-street parking, this home is the one for you!

The Ash Road shops are within easy walking distance, along with public transport and Leopold Kindergarten. Families will appreciate easy access to Leopold P.S and the Leopold Community Hub. Why not head to Lake Conewarre to enjoy the fresh air? Or spend an afternoon shopping at the Gateway Plaza? The Bellarine Highway keeps you connected to both Geelong and the Bellarine Peninsula.

It's easy to see that this home has been well-loved over the years, with updates including stylish bamboo flooring. The sunken lounge creates a cosy ambience with a wood heater, while the kitchen/dining zone flows through to the study. The kitchen is well equipped with a built-in pantry, dishwasher and Westinghouse cooking appliances (wall oven, 900mm gas cooktop, 900mm rangehood). Bathed in northern light, the generous sunroom inspires relaxatio

**Price:** UNDER CONTRACT

**Property Type:** House

**Land:** 780 m2

# HAYDEN

**Karen Purcell**

0448510143

karenp@haydenleopold.com.au

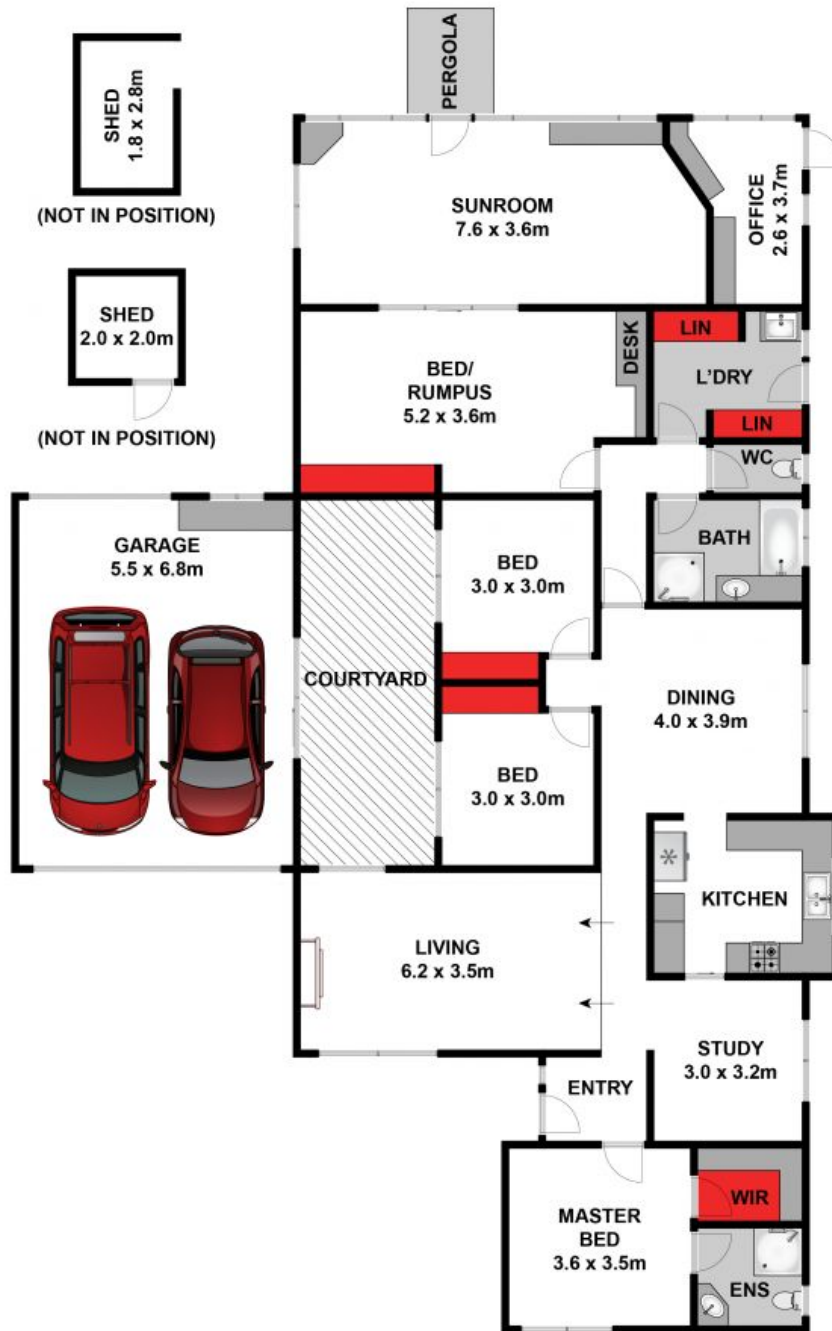

Approx House Area 258m<sup>2</sup>

Whilst [bwrn.com.au](http://bwrn.com.au) has made every attempt to ensure the accuracy of the floor plan contained here, measurements are approximate and no responsibility is taken for any error, omission, or mis-statement. This plan is for illustrative purposes only.



**34 Hazelwood Crescent, Leopold**

**HAYDEN**

34 Hazelwood Crescent

LEOPOLD, VIC