



62-80 Matthews Road LEOPOLD, VIC



5



3



4

Exclusive Family Living on Picturesque Acreage!

Don't miss this rare opening to secure an exclusive lifestyle property upon approx. 27 acres! The bespoke home showcases a solar-heated pool and stunning entertaining options, while the expansive grounds back onto the natural delights of Reedy Lake. With the property home to six paddocks and a sheep run, this is an irresistible choice for farmers, horse-owners, or those interested in agistment opportunities.

You'll be amazed when you lay eyes on the swimming pool and luxury pool house. Boasting a bathroom, outdoor kitchen and gas log fireplace, this pool house takes outdoor entertaining to a whole new level. The firepit zone is perfect for chilly nights under the stars, while the secure backyard features a cubby house. You'll love how the rural outlook captures breathtaking sunsets over the Highton hills. Home to a wisteria-draped pergola, the formal garden area is an absolute treat. Professionally landscaped to be self-sufficient, you ca

Price: \$2,300,000 - \$2,500,000
Inspect: Saturday, 17th April 2021 12:30 - 1:00
Property Type: House
Land: 11.1 Hectares



Karen Purcell

0448510143

karenp@haydenleopold.com.au

Robyn Grumley

0448510134

robyn@haydenleopold.com.au

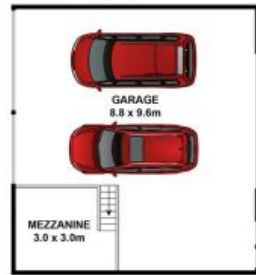
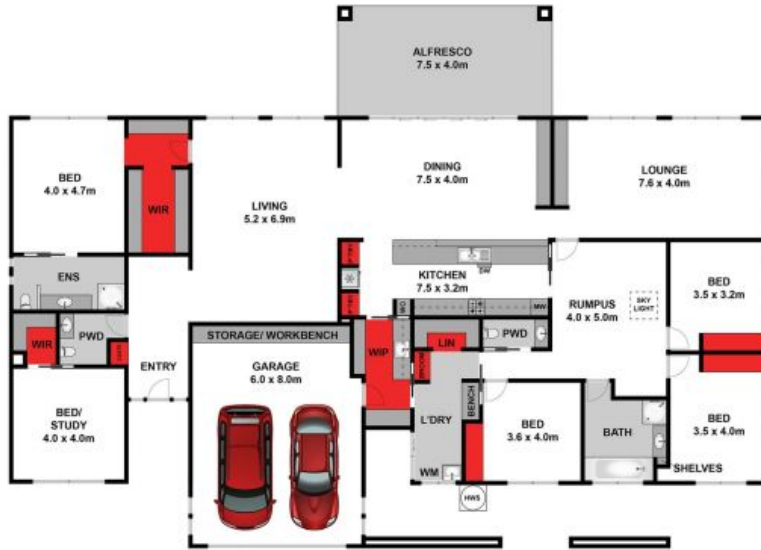

(NOT IN POSITION)

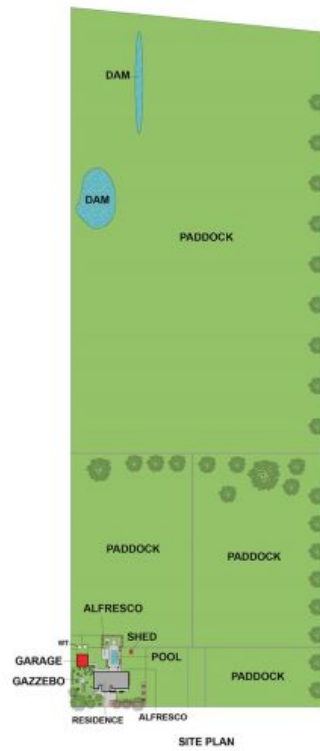

Approx House Area 364m²
 Approx Land Area 110982m²

Whilst bwr.com.au has made every attempt to ensure the accuracy of the floor plan contained here, measurements are approximate and no responsibility is taken for any error, omission, or mis-statement. This plan is for illustrative purposes only.



62 - 80 Matthews Road, Leopold



62-80 Matthews Road

LEOPOLD, VIC