



19 Camp Road ANGLESEA, VIC



Base Camp Without Compromise

This low maintenance brick and tile home is only five years old and it feels like new. It is the perfect size for anyone looking for a comfortable modern home in a great location.

There is effortless connection to outdoor living from the meals area through a sliding door on to a patio. The 460m² (approx) allotment feels spacious and comes with abundant veggie beds.

Price: \$975,000- \$999,000

Property Type: House

Land: 460 m2

HAYDEN

Darcy Bennett

0468427359

darcyb@hayden.com.au

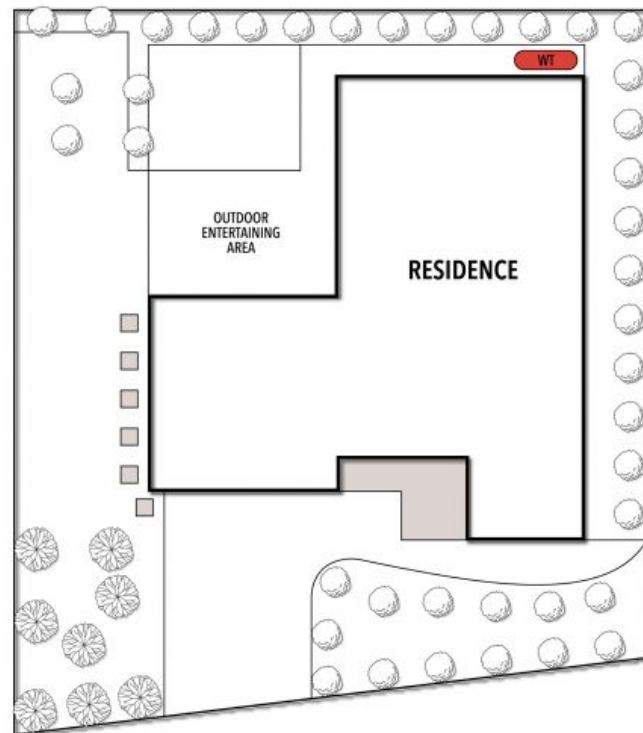
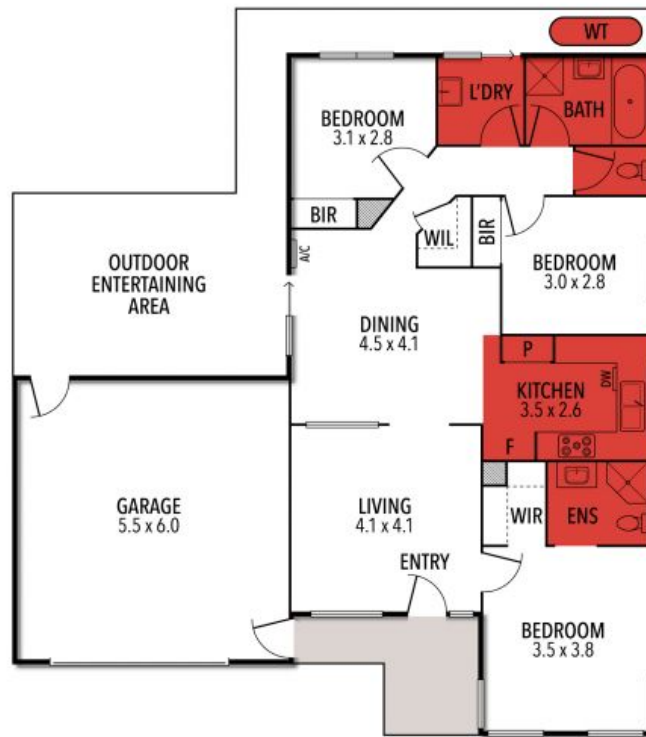

THE ABOVE PLAN IS AN ARTIST'S IMPRESSION ONLY, IT INCLUDES ELEMENTS THAT ARE FOR DISPLAY PURPOSES ONLY AND MAY NOT BE TO SCALE. LANDSCAPING SHOWN IS INDICATIVE ONLY.