



19 Camp Road ANGLESEA, VIC



## Base Camp Without Compromise

This low maintenance brick and tile home is only five years old and it feels like new. It is the perfect size for anyone looking for a comfortable modern home in a great location.

There is effortless connection to outdoor living from the meals area through a sliding door on to a patio. The 460m<sup>2</sup> (approx) allotment feels spacious and comes with abundant veggie beds.

**Price:** \$975,000- \$999,000

**Property Type:** House

**Land:** 460 m2

# HAYDEN

**Darcy Bennett**

0468427359

darcyb@hayden.com.au

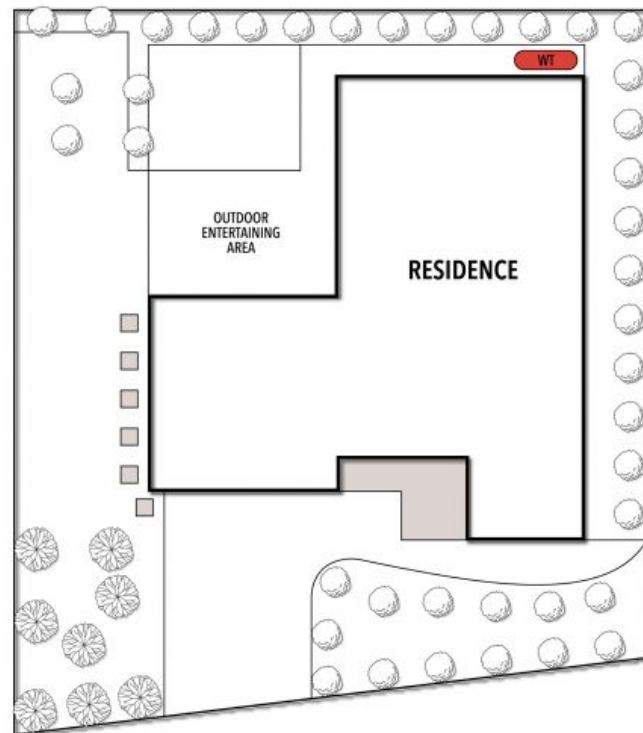
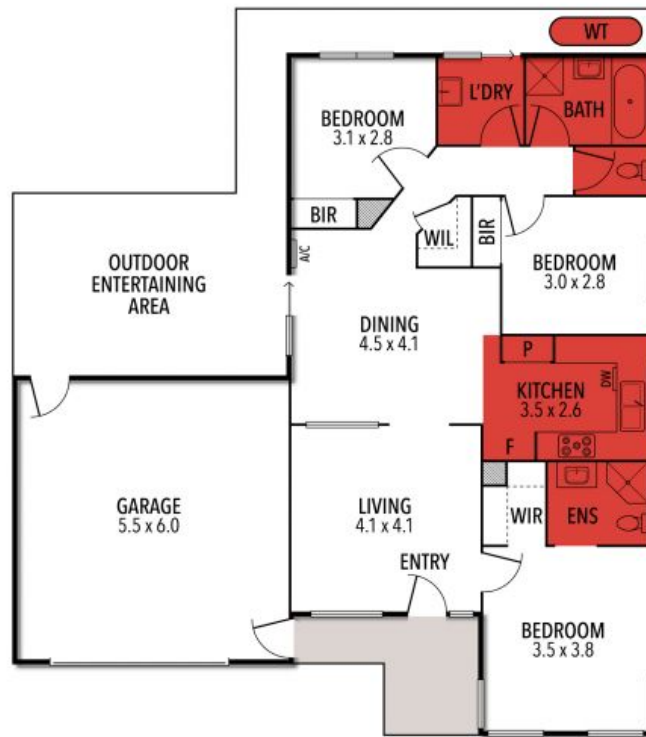

THE ABOVE PLAN IS AN ARTIST'S IMPRESSION ONLY, IT INCLUDES ELEMENTS THAT ARE FOR DISPLAY PURPOSES ONLY AND MAY NOT BE TO SCALE. LANDSCAPING SHOWN IS INDICATIVE ONLY.