



51 Cypress Crescent LEOPOLD, VIC



3



1



3

The Perfect First Home or Downsizer!

Have you been searching for the perfect first home or downsizer? Featuring immaculate interiors, a north-facing backyard and ample off-street parking, this property is an absolute gem!

Price: \$500,000 - \$550,000

Property Type: House

Land: 482 m2

Brimming with standout features, this home is an absolute treat! Inspect without delay!

HAYDEN

Karen Purcell

0448510143

karenp@haydenleopold.com.au

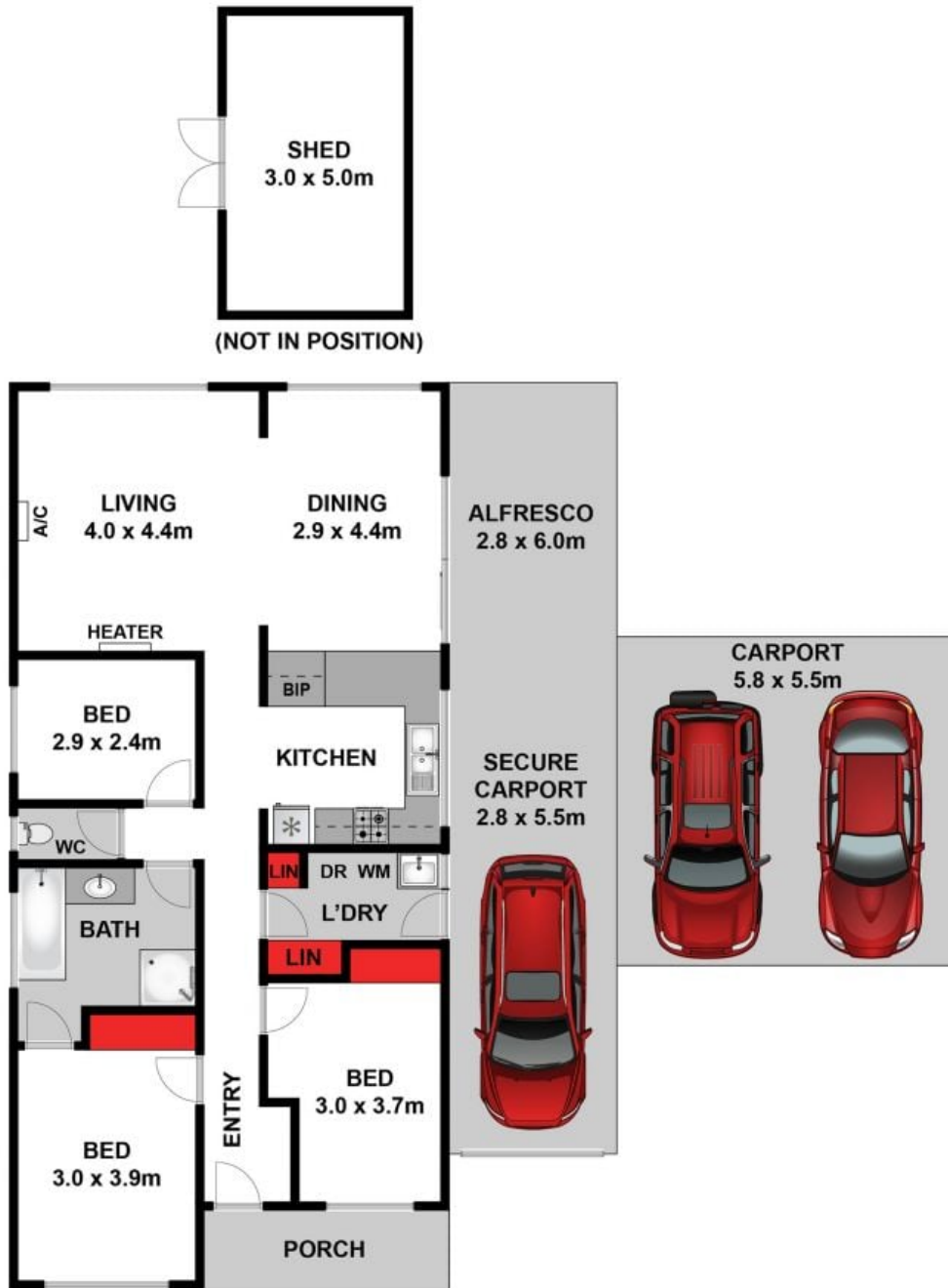

Approx House Area 105m²

Whilst bwrn.com.au has made every attempt to ensure the accuracy of the floor plan contained here, measurements are approximate and no responsibility is taken for any error, omission, or mis-statement. This plan is for illustrative purposes only.



51 Cypress Crescent, Leopold

HAYDEN

51 Cypress Crescent

LEOPOLD, VIC