



51 Cypress Crescent LEOPOLD, VIC



3



1



3

## The Perfect First Home or Downsizer!

Have you been searching for the perfect first home or downsizer? Featuring immaculate interiors, a north-facing backyard and ample off-street parking, this property is an absolute gem!

**Price:** \$500,000 - \$550,000

**Property Type:** House

**Land:** 482 m2

Brimming with standout features, this home is an absolute treat! Inspect without delay!

# HAYDEN

**Karen Purcell**

0448510143

karenp@haydenleopold.com.au

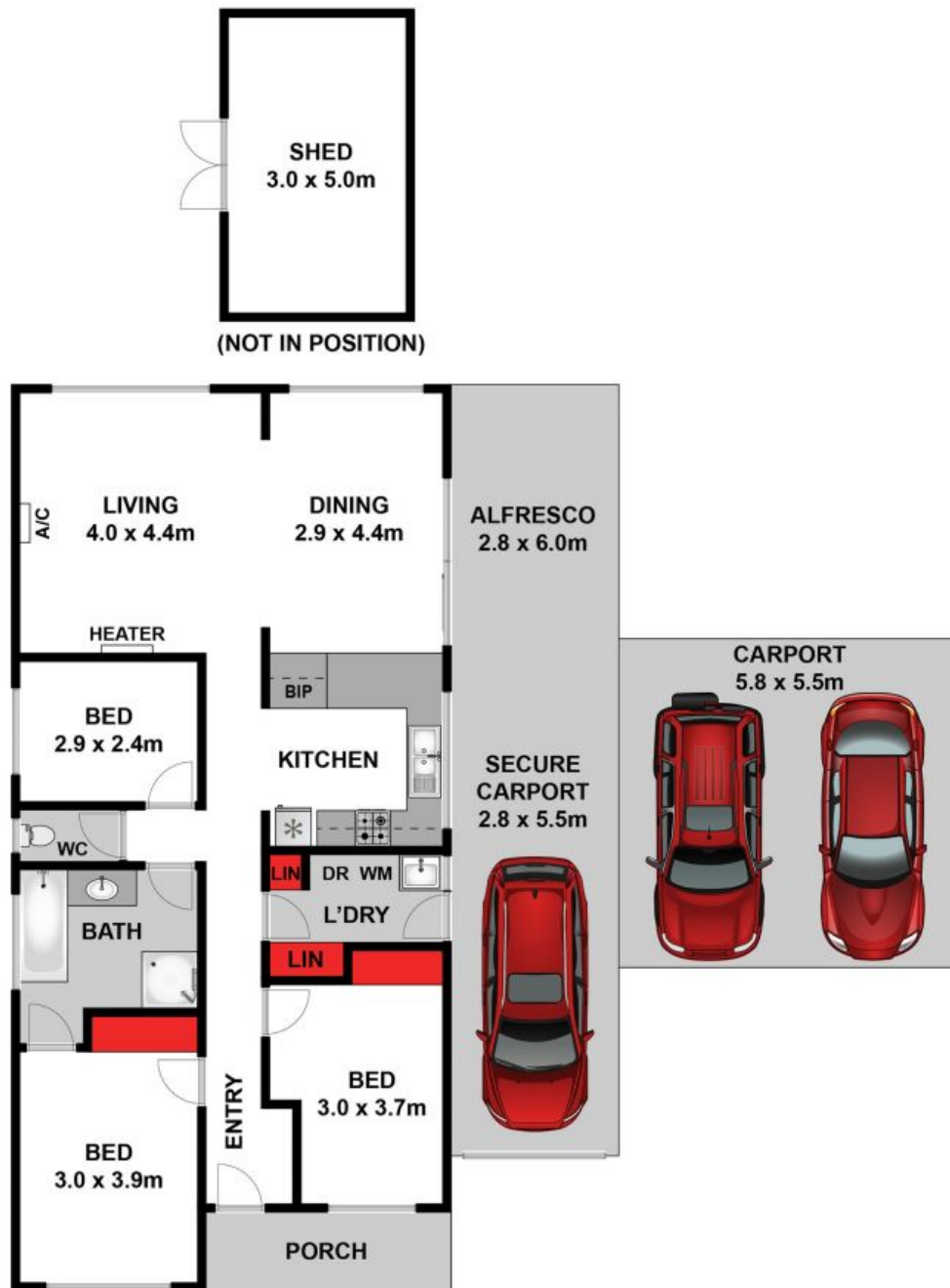

Approx House Area 105m<sup>2</sup>

Whilst [bwwm.com.au](http://bwwm.com.au) has made every attempt to ensure the accuracy of the floor plan contained here, measurements are approximate and no responsibility is taken for any error, omission, or mis-statement. This plan is for illustrative purposes only.



**51 Cypress Crescent, Leopold**

**HAYDEN**

**51 Cypress Crescent**

**LEOPOLD, VIC**