



12 Donvale Drive LEOPOLD, VIC



3



2



3

Spacious Family Living Brimming With Potential!

Occupying approx. 696m², this original home puts the foundations in place for families and renovators alike (STCA)!

Zoned to the rear of the home for privacy, the Master Bedroom features dual built-in robes and an en suite. Two additional bedrooms with built-in robes, main bathroom, separate toilet and laundry complete the layout.

You'll need to act quickly to avoid disappointment!

Terms: 10% deposit, balance 30 days

Price: Price Guide: \$520,000 - \$570,000
Property Type: House
Land: 696 m²

HAYDEN

Karen Purcell

0448510143

karenp@haydenleopold.com.au

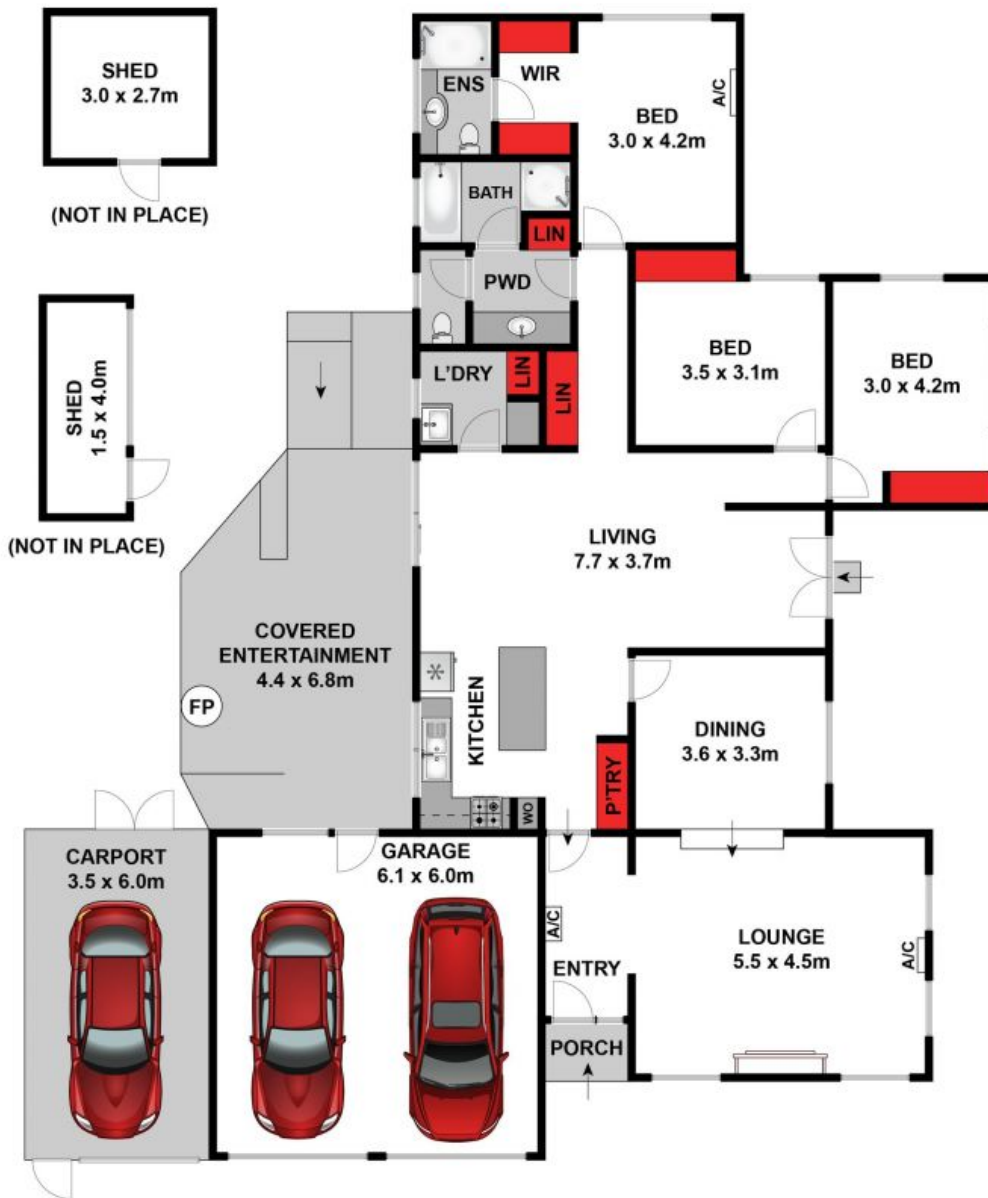

Approx House Area 198m²

Whilst bwrn.com.au has made every attempt to ensure the accuracy of the floor plan contained here, measurements are approximate and no responsibility is taken for any error, omission, or mis-statement. This plan is for illustrative purposes only.

12 Donvale Drive, Leopold

HAYDEN

12 Donvale Drive

LEOPOLD, VIC