



10 Haven Court TORQUAY, VIC



4



4



2

Park Side Haven

This home has been renovated to exacting standards. It feels like new while retaining its coastal charm and has the added bonus of a sunny park side setting. It blends the best of beach house living with a fresh and contemporary finish.

Recently redecorated inside and out, with new window joinery, carpets, light fittings and beautiful engineered timber flooring set in a stylish herringbone pattern, it's safe to say that all the hard work has been taken care of.

The 942m² (approx) allotment boasts picturesque gardens with established fruit trees and lush lawns. The grounds are fully fenced and private with direct gate access to the adjoining park. Enjoy easy access to a walking track through Deep Creek Reserve to the beach.

Price: Contact Agent
Property Type: House
Land: 942 m2

HAYDEN

Hayden Real Estate Ben Smith

0423050825

Torquay

samh@hayden.com.au

bens@hayden.com.au

10 HAVEN COURT, TORQUAY

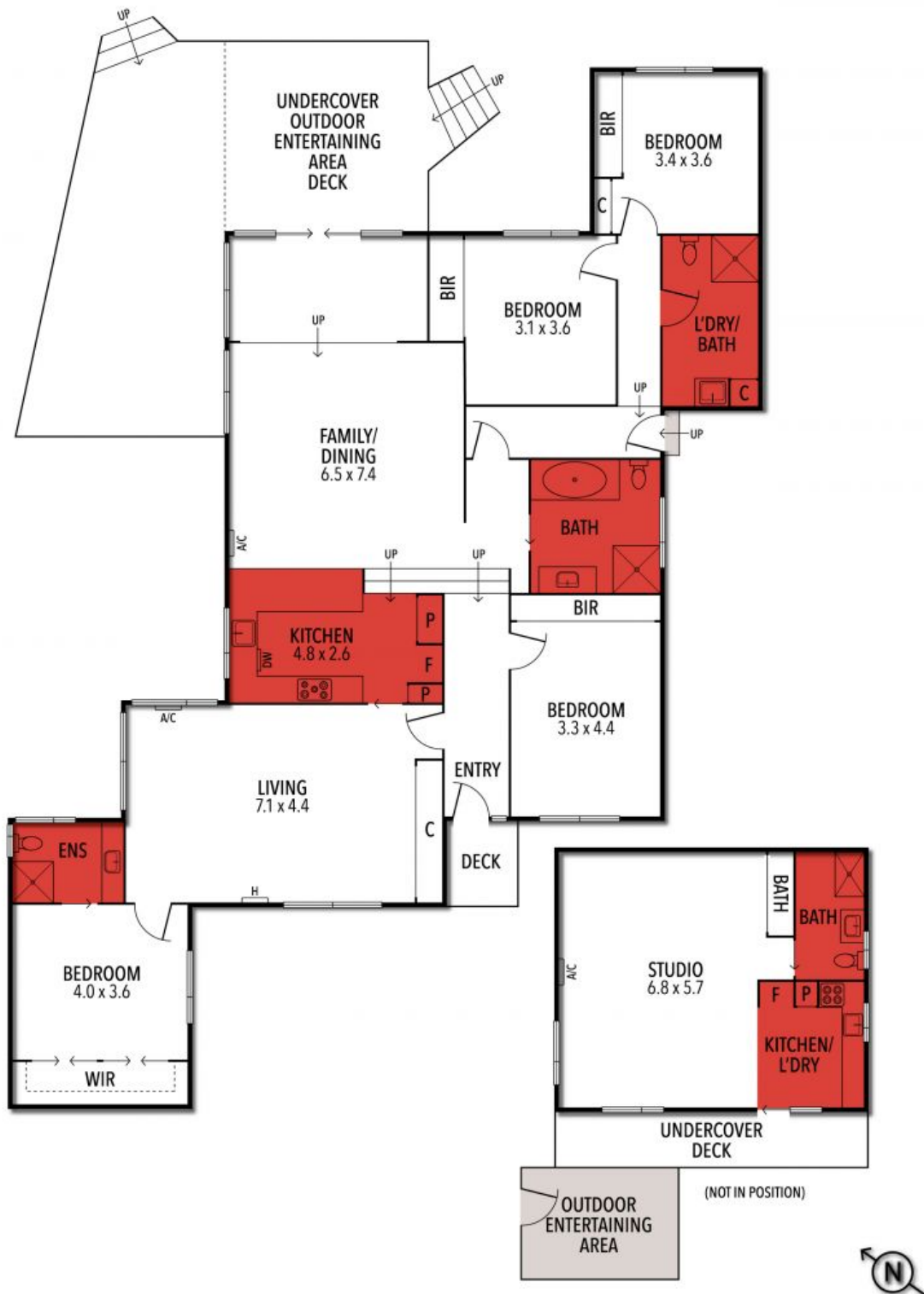

THE ABOVE PLAN IS AN ARTIST'S IMPRESSION ONLY, IT INCLUDES ELEMENTS THAT ARE FOR DISPLAY PURPOSES ONLY AND MAY NOT BE TO SCALE. LANDSCAPING SHOWN IS INDICATIVE ONLY. DIMENSIONS ARE APPROXIMATE.