



21 Hilda Avenue OCEAN GROVE, VIC



3



1



1

## Mid Century Beach House

Boasting a retro vibe and offering endless opportunities to either improve or embrace its unique style, this original mid century beach house is set across 613m<sup>2</sup> in a peaceful, quiet pocket of old Ocean Grove. Securely fenced, the north facing front garden is a sheltered sun trap with a timber deck overlooking olive tree hedging and mature plantings. A side gate leads to off street parking for two cars and space for a trailer.

**Price:** \$760,000-\$790,000

**Property Type:** House

**Land:** 613 m<sup>2</sup>

# HAYDEN

**Penny Dawson**

0448510200

penny@haydenoceanogrove.com.

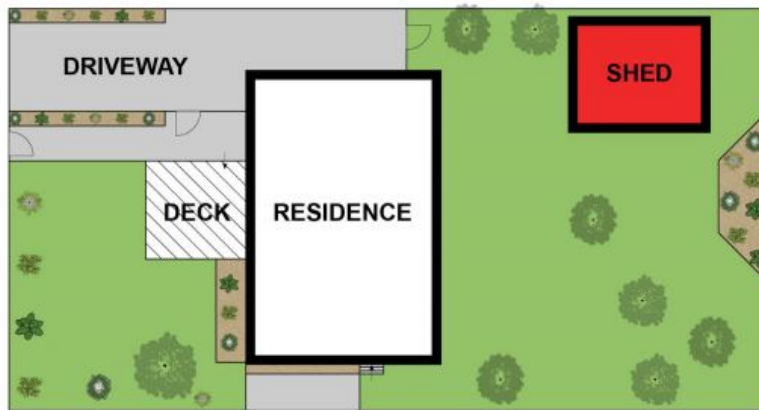
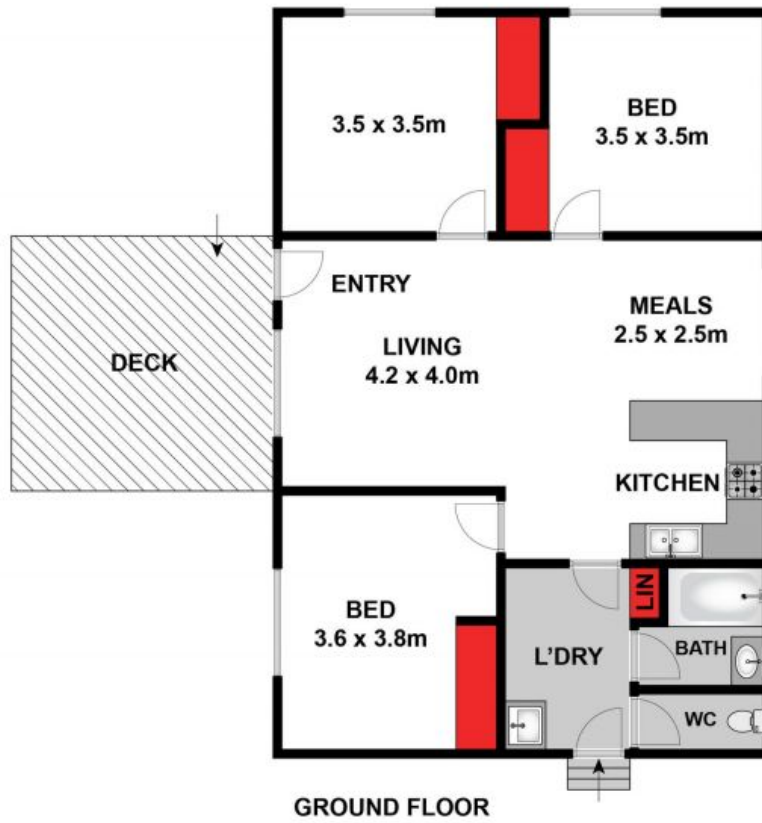

Approx House Area 96m<sup>2</sup>  
 Approx Land Area 613m<sup>2</sup>

Whilst [bwrn.com.au](http://bwrn.com.au) has made every attempt to ensure the accuracy of the floor plan contained here, measurements are approximate and no responsibility is taken for any error, omission, or mis-statement. This plan is for illustrative purposes only.



**21 Hilda Avenue, Ocean Grove**

**HAYDEN**

21 Hilda Avenue

OCEAN GROVE, VIC