



21 Hilda Avenue OCEAN GROVE, VIC



3



1



1

Mid Century Beach House

Boasting a retro vibe and offering endless opportunities to either improve or embrace its unique style, this original mid century beach house is set across 613m² in a peaceful, quiet pocket of old Ocean Grove. Securely fenced, the north facing front garden is a sheltered sun trap with a timber deck overlooking olive tree hedging and mature plantings. A side gate leads to off street parking for two cars and space for a trailer.

Price: \$760,000-\$790,000

Property Type: House

Land: 613 m²

HAYDEN

Penny Dawson

0448510200

penny@haydenoceanogrove.com.

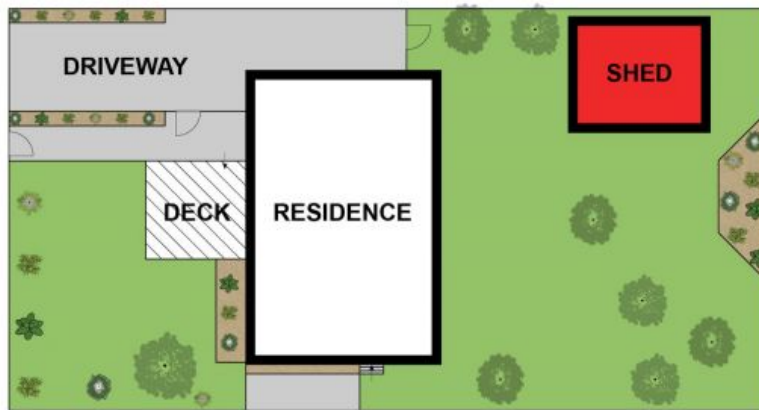
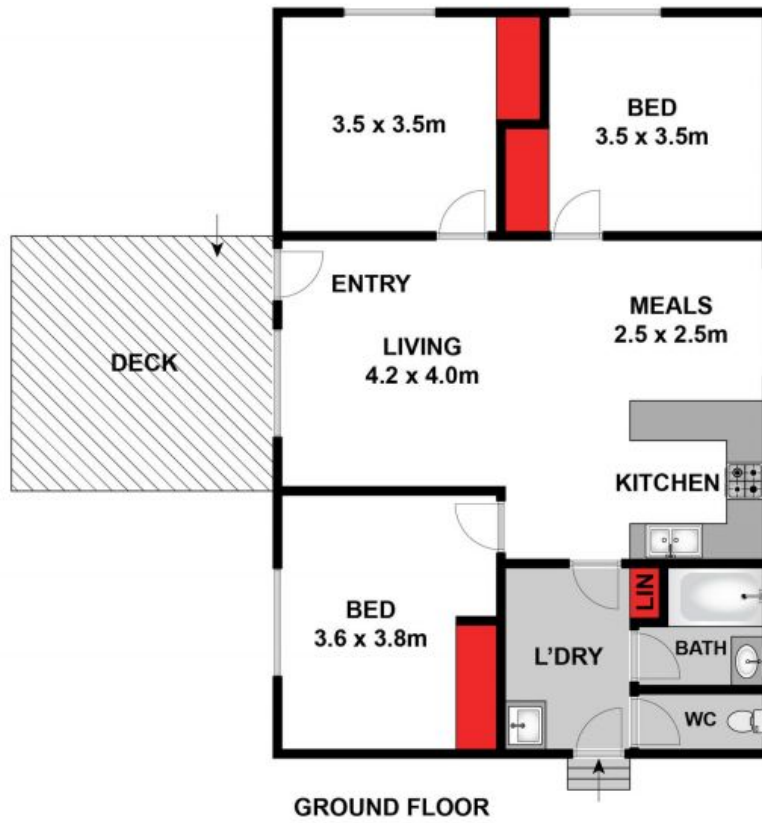

Approx House Area 96m²
 Approx Land Area 613m²

Whilst bwrn.com.au has made every attempt to ensure the accuracy of the floor plan contained here, measurements are approximate and no responsibility is taken for any error, omission, or mis-statement. This plan is for illustrative purposes only.



21 Hilda Avenue, Ocean Grove

HAYDEN

21 Hilda Avenue

OCEAN GROVE, VIC