

19 Birdie Avenue ANGLESEA, VIC



3



2



4

Ideal Family Home or Holiday Escape

Don't miss out book a private appointment today!

The ideal family home or holiday escape on a lovely 585sqm allotment, what a great offering 19 Birdie Avenue, Anglesea truly is!

- >North facing living area
- >Sealed driveway with ample off street parking space
- >Quiet location, the perfect place to relax
- >Approx. 585sqm
- > Flexible floorplan
- > Leafy outlook

Price: Contact Agent
Property Type: House
Land: 585 m2

HAYDEN

Darcy Bennett

0468427359

darcyb@hayden.com.au

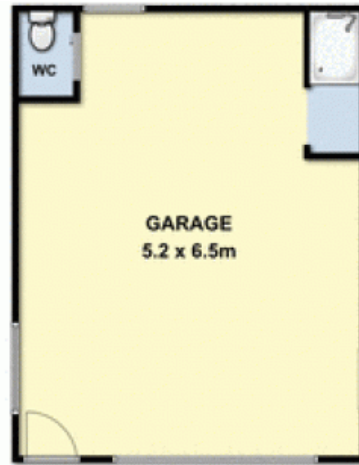
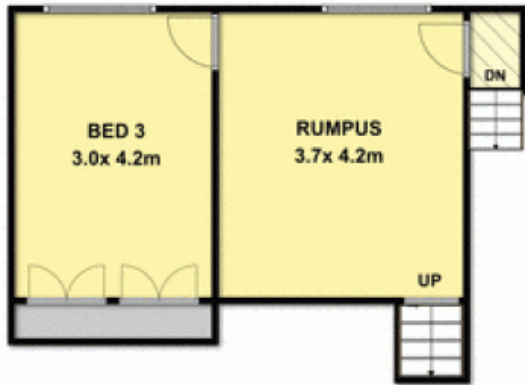

NOT IN POSITION



THIS FLOOR PLAN IS A SKETCH ALL DATA SHOWN IS GENERAL ONLY NB: ALL DIMENSIONS STATED ARE APPROXIMATE ONLY AND SHOULD NOT BE TAKEN AS DEFINITE

19 Birdie Avenue

ANGLESEA, VIC