



42 Pickworth Drive LEOPOLD, VIC



3



2



2

Open for Private Inspections - Contact us for a booking

Family Living That Ticks Every Box!

Don't miss this chance to secure a terrific family home in a peaceful pocket of Leopold!

Price: \$570,000 - \$610,000

Property Type: House

Land: 452 m2

HAYDEN

Karen Purcell

0448510143

karenp@haydenleopold.com.au



(NOT IN PLACE)

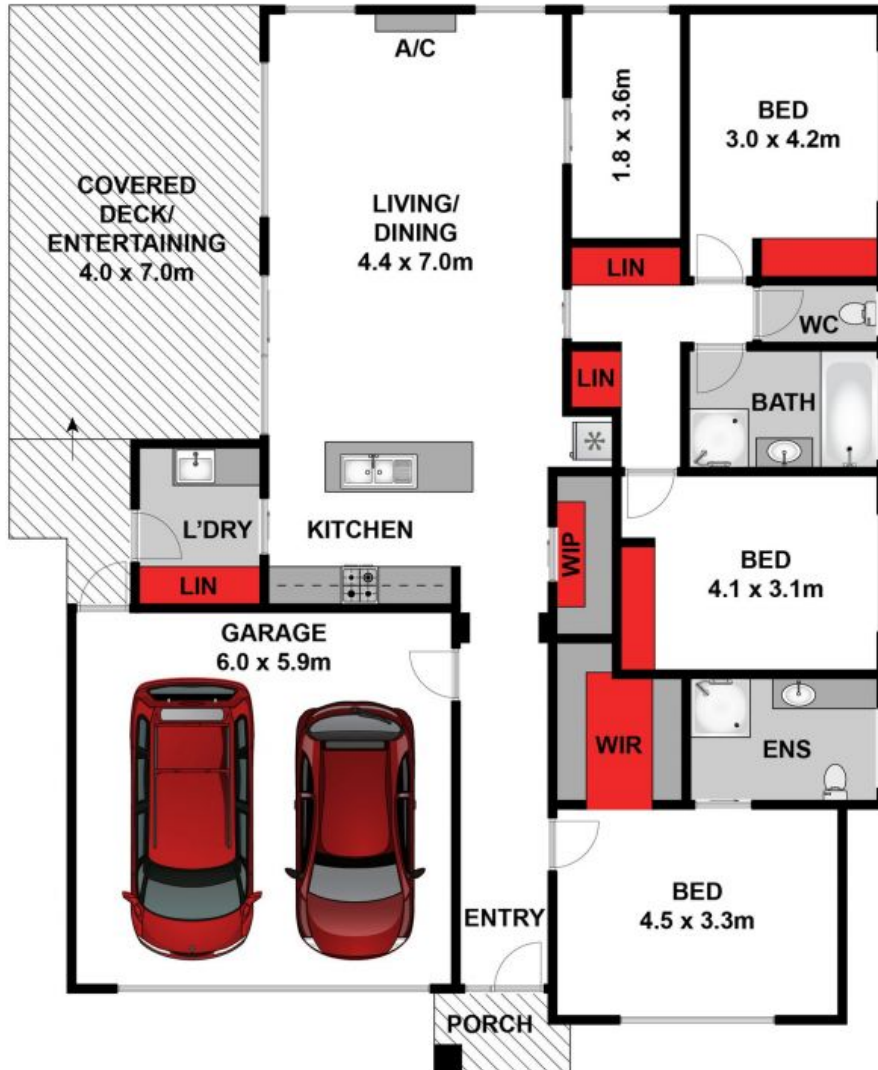

Whilst bwrn.com.au has made every attempt to ensure the accuracy of the floor plan contained here, measurements are approximate and no responsibility is taken for any error, omission, or mis-statement. This plan is for illustrative purposes only.

42 Pickworth Drive, Leopold

HAYDEN

42 Pickworth Drive

LEOPOLD, VIC