



42 Pickworth Drive LEOPOLD, VIC



3



2



2

Open for Private Inspections - Contact us for a booking

Family Living That Ticks Every Box!

Don't miss this chance to secure a terrific family home in a peaceful pocket of Leopold!

**Price:** \$570,000 - \$610,000

**Property Type:** House

**Land:** 452 m2

HAYDEN

**Karen Purcell**

0448510143

karenp@haydenleopold.com.au

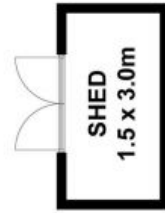

(NOT IN PLACE)

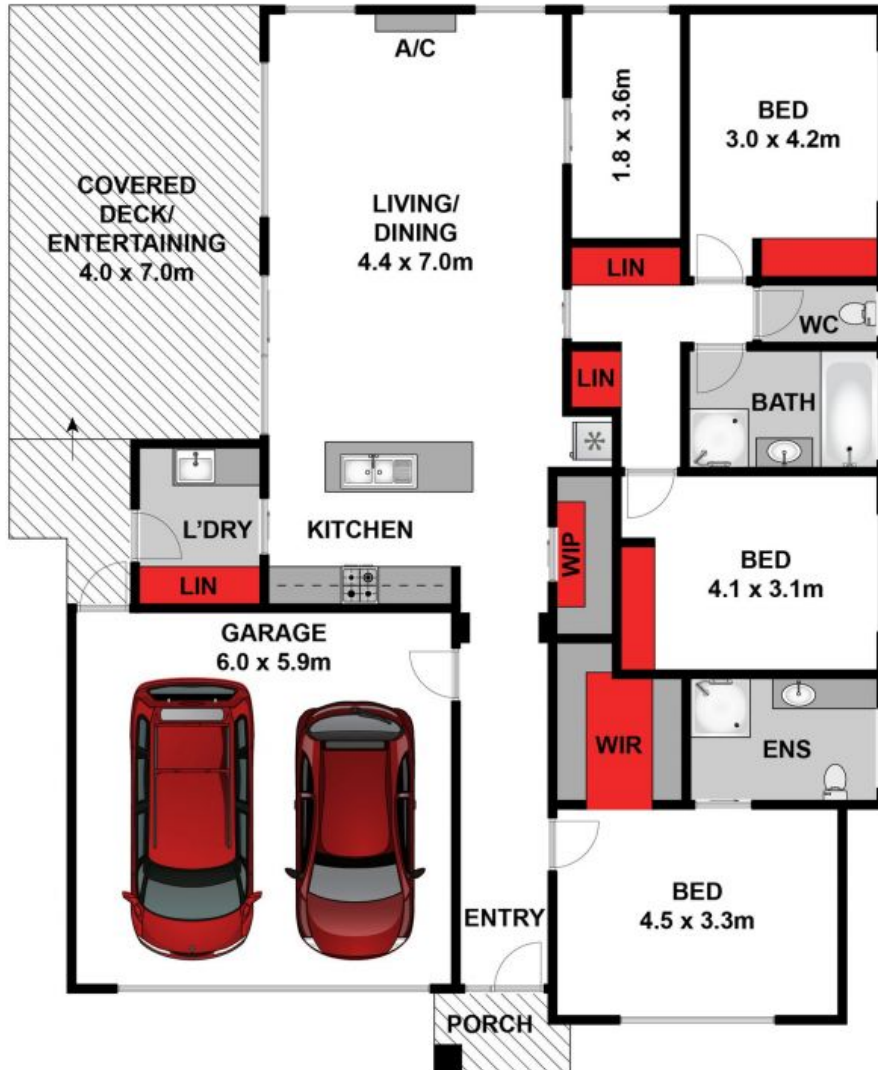

Whilst [bwrn.com.au](http://bwrn.com.au) has made every attempt to ensure the accuracy of the floor plan contained here, measurements are approximate and no responsibility is taken for any error, omission, or mis-statement. This plan is for illustrative purposes only.

42 Pickworth Drive, Leopold

**HAYDEN**

42 Pickworth Drive

LEOPOLD, VIC