



50 Cresta Street LEOPOLD, VIC



3



2



1

Welcome Home....

With nothing left to do except move in and enjoy, this home is the perfect family package!

The morning school run is a breeze with Leopold Primary School and Leopold Kindergarten within easy walking distance. The Ash Road shops are also a short stroll away, along with local playgrounds and public transport. The Gateway Plaza provides you with an abundance of shopping and dining options, while the Bellarine Highway grants easy access to Geelong and the Bellarine Peninsula.

Northern light sweeps through the Master Bedroom, which features built-in robes and an en suite with dual shower. Two additional bedrooms with built-in robes are serviced by the main bathroom, which boasts an open shower and bathtub. The laundry and separate toilet complete the floorplan. You'll be in comfort all year long thanks to ducted heating, two split

Price: \$550,000 - \$600,000

Property Type: House

Land: 653 m2

HAYDEN

Karen Purcell

0448510143

karenp@haydenleopold.com.au

Robyn Grumley

0448510134

robyn@haydenleopold.com.au

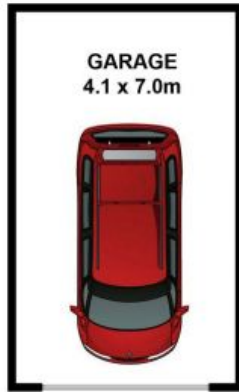

(NOT IN POSITION)

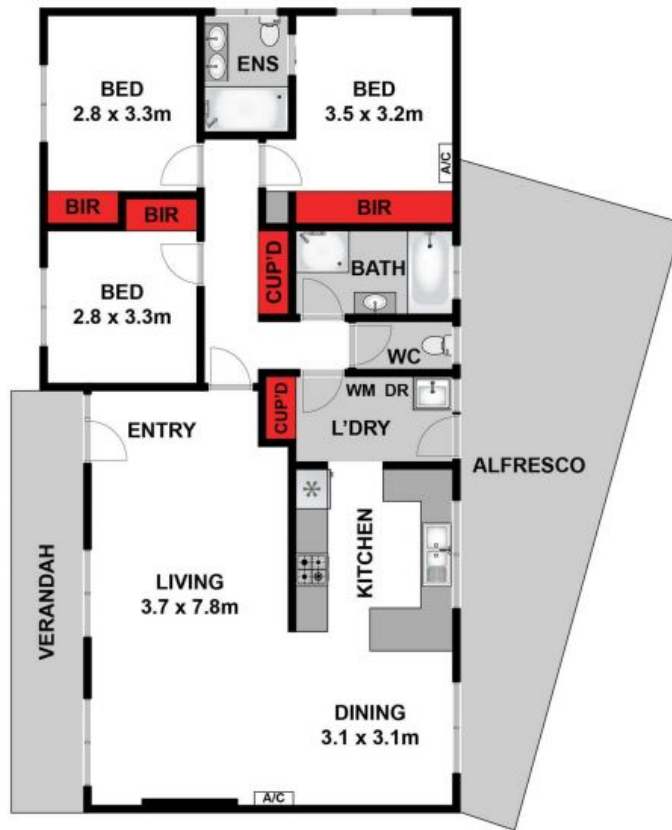

Whilst bwrn.com.au has made every attempt to ensure the accuracy of the floor plan contained here, measurements are approximate and no responsibility is taken for any error, omission, or mis-statement. This plan is for illustrative purposes only.



50 Cresta Street, Leopold

HAYDEN

50 Cresta Street

LEOPOLD, VIC