



28 Silver Gull Court LEOPOLD, VIC



4



2



2

### Fantastic Family Living - Private Inspections Only

Extras include a double garage with an additional bay (ideal for setting up a workshop or extra storage), ducted heating, split system air conditioning, artificial turf for no-maintenance lawns, a garden shed and a 1000L water tank. For modern family living conveniently located near amenities and parklands, look no further!

**Price:** \$690,000-\$750,000

**Property Type:** House

**Land:** 672 m2

# HAYDEN

Hayden Real Estate -

**Ocean Grove**

samh@hayden.com.au

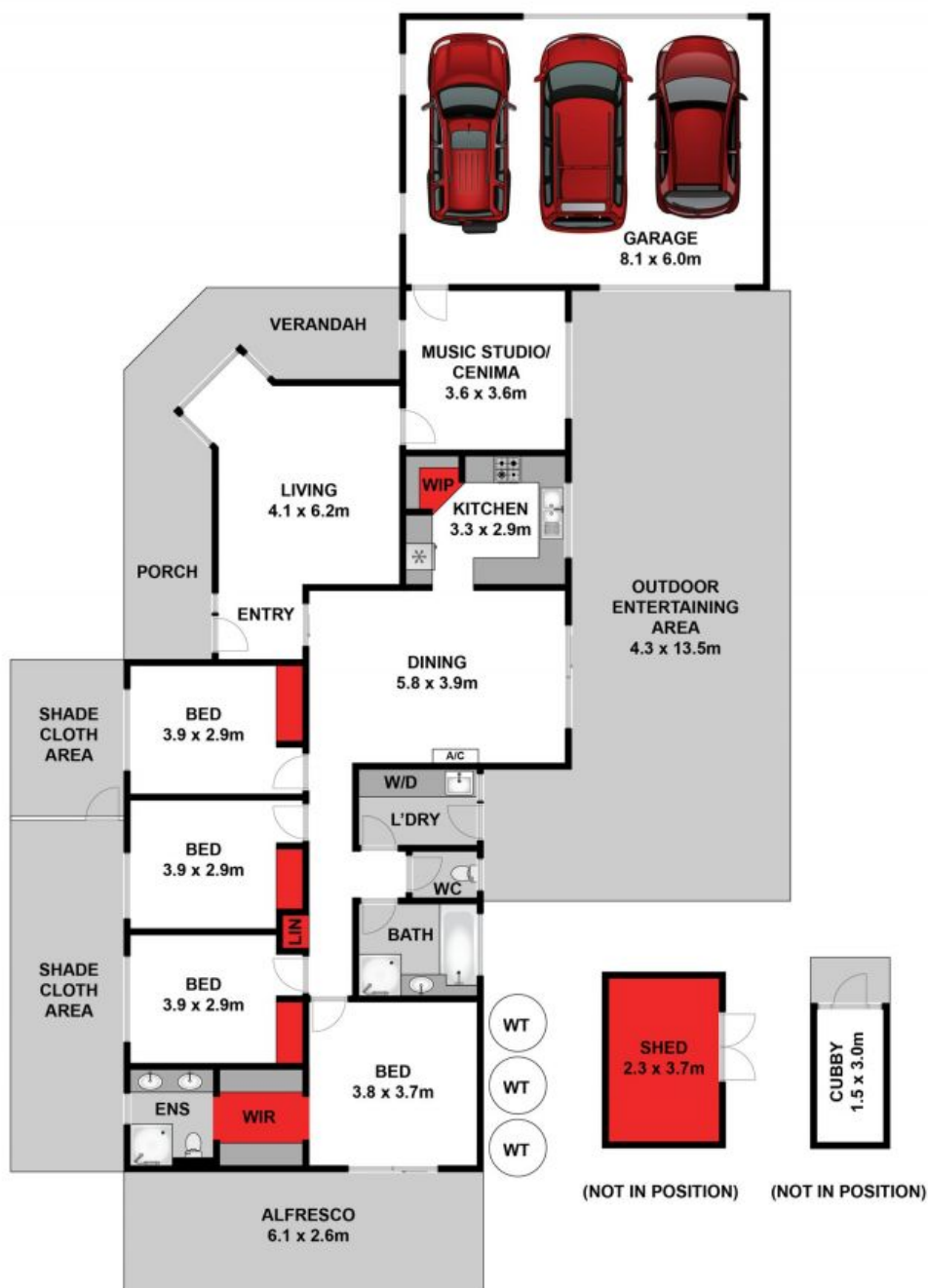

Whilst [bwrn.com.au](http://bwrn.com.au) has made every attempt to ensure the accuracy of the floor plan contained here, measurements are approximate and no responsibility is taken for any error, omission, or mis-statement. This plan is for illustrative purposes only.



28 Silver Gull Court, Leopold

**HAYDEN**

28 Silver Gull Court

LEOPOLD, VIC