



2/48 Huon Crescent LEOPOLD, VIC



2



1



1

Low-Maintenance Living That Feels Like Home! - Private Inspections Only

Have you been searching for low-maintenance living that feels just like home? Whether you're dreaming of breaking into the property market, searching for a superb downsizer, or hoping to grow your investment portfolio, this is the one for you!

Price: \$495,000 - \$544,000
Property Type: Unit
Land: 366 m2

You'll need to act swiftly to secure this Leopold gem!

HAYDEN

Karen Purcell

0448510143

karenp@haydenleopold.com.au

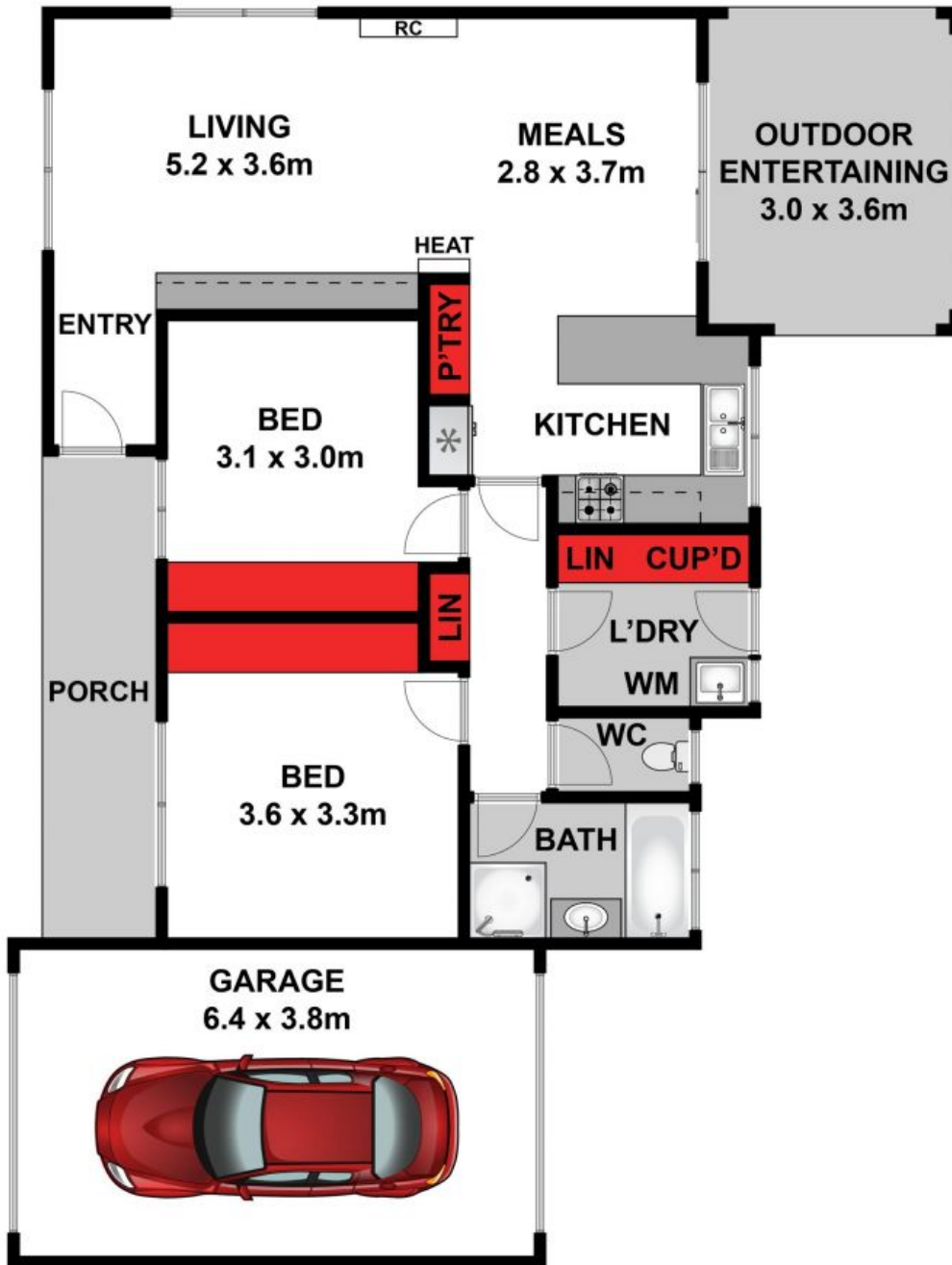

Whilst bwrn.com.au has made every attempt to ensure the accuracy of the floor plan contained here, measurements are approximate and no responsibility is taken for any error, omission, or mis-statement. This plan is for illustrative purposes only.



2/48 Huon Crescent, Leopold

HAYDEN

2/48 Huon Crescent

LEOPOLD, VIC